

5-VKMATV150HXL

ATV MOWER



Kellfri

Read this manual carefully
before using the product!
Translated from the original

CONTENTS

Introduction	3
Product information	4
Intended use	5
Technical data	5
Safety information	6
Product safety information	6
Surroundings	7
Incase of emergencies	7
Personal protection	7
Warning labels	8
Before use	9
Operation	10
Riskrisks and hazards of use of mowing machine	10-11
Setting of drawbar	12
Start the engine	13
Driving and speed	13
After use	14
Transport mode	14
Transportation and storage	14
Maintenance and service	15
Service intervals / maintenance	15
Inspection	16
Inspection of v-belt	16
Inspection of rotor bearings	17
Inspection of wheel bearings	17
Maintenance of knives	17
Support roller and side rails	18
Assembly	19
Recycling	20
Machine assembly	22-23
Driving system assembly	24
Wheel assembly	25
Towing bar assembly	26
Complaint form	27
Ec-declaration of conformity	28

INTRODUCTION

Thank you for choosing a product from Kellfri AB. By following general safety information, operating instructions and common sense, you will have many years of enjoyable use of the product. Kellfris equipment and products are aimed to be use by active farmers with high demands on functionality.

PRODUCT INFORMATION

- 32 Heavy Duty hammer flails weighing 354 g each: Robust cast flails for grass and saplings
- Working width 150 cm
- Strong bogie clevis with two 19x7-8 wheels on each side
- Adjust the angle of operation with the turnbuckle under the tow bar
- Skids at the sides for stable, smooth operation
- Chain guard at the front to protect against ejected stones and clippings
- Openable rear flap
- 23 hp V-twin motor with 673CC
- Electric start-up
- Wheel base width 219 cm
- Moveable tow bar, right hung and centrally hung mounting

Robust chassis and bogie means that it can cope with most situations. The bogie enables the machine to run smoothly and it is responsive in tough and uneven terrain. A roller with Heavy Duty hammer flails weighing 354 g each makes cutting long grass and even saplings an easy task with your ATV Flail Mower.

Its weight of 405 kg provides an effective force to press down branches and vegetation, delivering an excellent cutting performance. In order to achieve maximum power transmission from the 23 hp V-twin engine to the roller, the flail mower has been equipped with 3 cog belts and a powerful belt tensioner.

The tow bar is adjustable in five steps, it can also be positioned centrally on the chassis, which is unique for the industry. The flail mower can therefore be operated on both sides of your ATV; in other words, it can be centrally mounted and also right-hung on the chassis.

Increase speed with a flail mower fitted with a flap

- Fitted with a flap at the back, which releases the grass to avoid excessive accumulation under the hood. You save on fuel and reduce wear on the belts, and you can also operate at a higher speed than an ATV flail mower without a flap. The grass is also spread more evenly.
- Deals with tougher vegetation where there may be ground obstacles such as tussocks and roots
- Used primarily for topping pastures, parks and road verges
- Stable construction

It is recommended to open the rear flap when cutting very rough terrain.

Flail mower built for a long service life

- Grease nipples on support and rotor roller bearings
- Sealed cover over the belts
- The whole construction is well-protected but easy to access for cleaning, servicing and repair
- Wide support roller at the rear
- The tow bar has five fixed lateral adjustments

INTENDED USE

The equipment is intended to only cut and trim grass. Make sure that there are no rocks or obstacles in the fields before you start the operation.





Caution!

The machine is delivered without engine oil!

TECHNICAL DATA

Working width	1500 mm
Power requirements	23 hk
Wheels 4x	19x7-8
Cutting height	Justerbar
Operating speed	6-12 km/h
L x W x H	1720 x 2190 x 1100
Flails	32 st hammarslagor Heavy duty, 77 mm/354 g
Weight	405 kg



WARNING!

The machine's original design must not under any circumstances be changed without the permission of the manufacturer. Unauthorized modifications and / or accessories can result in life-threatening or fatal injury to the operator or others.

Warning symbols identify important safety aspects in this manual to help you and others avoid hazards and accidents. When using the machine: **Be extremely careful!**



DANGER!

This symbol indicates that a serious accident will occur if the instructions in the manual are not followed. The accident leads to serious injury, possibly death or serious property damage.



Warning!

This symbol indicates that an accident will occur if the instructions in the manual are not followed. The accident leading to serious injury or property damage.



CAREFUL!

This symbol indicates that an accident may occur if the regulations are not followed. The accident results in personal injury or property damage.

N.B!

N.B! indicates the potential of failure if the regulation is not followed.

SAFETY INFORMATION

Before using the product, please read the safety information and instruction manual and understand its contents for your own and others' safety. Always keep the safety information and instruction manual easily accessible to the user of the product. Remember that it may be good for your own and others' safety to read the safety information every now and then. If the instructions manual is damaged or otherwise unusable, please contact and order a new one from: Your retailer

The general safety instruction is also available from Kellfris website: www.kellfri.co.uk

Do not use this equipment if you are feeling sick, tired or in influence of alcohol. Nor if you are under the influence of strong medications or drugs, suffering from strong depression or severe mental illness. Always follow the general traffic rules and regulations and the rules of the Animal Welfare Act. Persons under 15 years old and people with mental illness may not use these product.



WARNING!

The machine's original design must not under any circumstances be changed without the permission of the manufacturer. Unauthorized modifications and / or accessories can result in life-threatening or fatal injury to the operator or others.

PRODUCT SAFETY INFORMATION

Read the instruction manual carefully before using the machine.

Do not use the machine in an inappropriate manner. Only use the machine as described in the manual.

Do not put hands or feet under the machine without stopping the machine and the engine

Never leave the equipment unattended while it's running. Turn off the engine and apply the parking brake when you leave, even for a short moment.

- Make sure that all guards are always correctly mounted and can not come loose.
- Only the operator is allowed in the vicinity of the machine during operation.
- Check before starting operation that no rocks are sticking up on the field.
- Always disengage the machine before performing service or maintenance work.
- Do not operate the mower if all the protective guards are correctly fitted.
- Do not turn off the engine immediately after hard work (see "turn off the engine").
- Do not run the engine in a closed area; exhaust fumes contains carbon dioxide which is can be fatal if inhaled.
- Do not operate the mower on steep slopes.
- Do not try to remove things that get stuck under the mower when the engine is running. Ensure that the engine and the rotor have stopped spinning before any action is taken on the mower.
- Do not operate the mower at night unless custom headlights are used.
- Do not drive with the mower if excessive vibration occurs, please stop the machine immediately and check the maintenance.
- Do not change the settings of the engine unless advised by the engine manufacturer.
- Do not use the mower unless all safety precautions are taken.
- Do not climb and never allow anyone to climb on the mower



WARNING!

Never use a tool or product with defective safety equipment.

SURROUNDINGS

Check and make sure that the area is clear of people, children and objects before switching on or using the equipment. Risk of serious personal injury. Be especially careful if children are in the area where the equipment is being use or stored. Check that there are no low-hanging power lines within the work area. Be careful when working on slopes and near ditches.

Always work alone with equipment designed for single - purpose tools/products. Never have junk/debris lying in your work area. Have workspaces clean. Always respect the risk zone.



DANGER!

Children in the area should be supervised!

INCASE OF EMERGENCIES

In case of an emergency please dial 999.

Keep cell phone or emergency phone available specially when working alone. First aid kit and fire extinguishers must be kept easily accesable during all work, maintenance and service.

PERSONAL PROTECTION

Always use suitable protection equipment. Do not wear loose clothing or jewellery while working with the equipment. Long hair should be tied up when working equipment that has moving parts. Use protective gloves as there is a risk of burns if any hot surfaces are touched such as exhaust pipes, and avoid getting oil and petrol on skin. Ear defenders must be worn whilst the engine is running.



WARNING LABELS

Make sure that the warning labels are always visible, clean the warning labels if necessary. Do not wash with high pressure washer directly on the warning label. If any part of the decal is worn or label becomes frayed or otherwise unreadable, order new decals. Symbols and explanations of the common signs and decals placed on the machine.

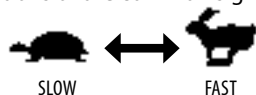

SLOW

FAST

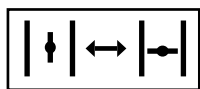

CHOKE



ENGINE OIL

I / O ON / OFF



STOP THE ENGINE



READ THE OPERATING MANUAL CAREFULLY BEFORE CARRYING OUT WORK



USE ONLY UNLEADED FUEL

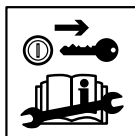

DISCONNECT THE MACHINE AND TURN OFF THE ENGINE BEFORE SERVICE OR REPAIR.



SMOKING IS NOT ALLOWED NEAR THE MACHINE



CAUTION! HOT SURFACE



CHECK OIL LEVEL



CAUTION! ROTATING KNIVES



WARNING!
ACCIDENT RISK FOR CHILDREN!



FIRE IS FORBIDDEN NEAR THE MACHINE



RESPECT THE MACHINE'S RISKZONE 15M
THE MACHINE IS MADE FOR SOLITARY
WORK ONLY!



WARNING! DANGEROUS FUMES!



THE PRODUCT IS CE-MARKED

BEFORE USE

Read the safety information and operating instructions carefully. Be sure that you understand the safety information, operating instructions and warning labels. Use common sense when using the machine and use appropriate personal protective equipment. Always check the performance and the machine combination that are used. It's highly important these matches in a satisfactory manner. This is to ensure the product or the function and most important yours and others safety.

Visually inspect the equipment or product before using it. Fix or replace damaged or worn parts immediately to reduce the risk of injury. Lubricate moving parts and check that all nuts and bolts are tightened.

Learn and remember correct working method. Beginners should keep a low speed until the person has learned how the machine works. The user / customer is responsible to handle the situation correctly. Do not use the machine if it is experienced to be dangerous for the user.. Read the tractor's manual before connecting the machine.

CHECK BEFORE EACH USE

- N.B.! The machine is delivered without engine oil! It is therefore important to fill it up before starting the engine.
- Check the engine oil level, top up if necessary.
- Check V-belt tension and adjust if necessary.
- Check that the flails are not defective, replace if necessary.
- Make sure that all nuts, bolts and fittings are securely attached, and all packing/shipping supplies such as tape, steel strips and rope, etc. are removed.
- Make sure the oil level is correct in the engine and there is fuel in the tank.
- Make sure the tire pressure is proper! max 14 PSI!
- Ensure that all protective parts are in place and won't loosen during operation
- Connect the equipment to ATV's tow ball.
- Put grease in all grease nipples
- Ready for use.

IMPORTANT! Retighten all bolts before start and after the first days use!

OPERATION

Only people who understand the safety information and operating instructions to operate this equipment or product. Be alert and cautious while working with the tool or product, and use only the tool or product in the manner described in the manual. When working with equipment that has moving parts, there is always the risk of injury. Be careful when working with equipment equipped with hydraulic hoses ,oil under pressure can penetrate the skin. Seek medical attention immediately if this occurs. Always work alone with the tools that are defined as single purpose tools. Respect the equipment's danger zone. Respect implement risk zone. All maneuvers occurs from the driver's seat.

- Lower the mower on the ground so that the support roller and the runners touches the ground.
- The machine is not made to process the ground, ensure that the blades do not touch the ground. Cutter head should only cut the grass
- Let the engine come up to right working speed before starting
- Set the towing vehicles speed for the material to be cut. The recommended speed is 3-10 km / h
- Lift the machine when operating on uneven ground.
- Reduce speed when operating on slopes and uneven terrain
- BE aware that different parts of the machine may be hot after use.
- Follow the guidance from ATV manufacturer who provides evidence regarding towing / pulling of equipment / tools
- Be careful when you filling the tank with fuel, especially when some parts are hot.

Tips for use:

For best results, and a longer service life for belts, we recommend mowing at a speed of 10 km/h if the grass is of normal height. For higher grass, raise the mower to its maximum and mow twice.

RISK RISKS AND HAZARDS OF USE OF MOWING MACHINE

Risk of crushing

Bystanders may be injured when the machine is lowered to the cutting position. The machine has crushing points around the hinge areas and between the three-point hitch mount and the main body.

Rotating blades

All persons will be at risk of injury if they stick out their hands or feet under the machine when it is lifted from the ground and the blades are rotating.

Risk of pinching or risk of trapping body parts

This risk is common in transmission devices such as belt drives, gears and rollers. Ensure that all guards are fitted correctly.

Risk during disengaging of the machine

The heavier the rotating part is, the longer it will continue to rotate after the drive has been switched off. This feature is called "free-wheeling" . Rotating blades and other components, such as drive shafts, etc. will continue to spin after the drive has been disconnected. Damages:

- When the operator releases the equipment, and try to clean or adjust the machine before the components have stopped rotating.
- When the shear bolt in the protective device in the power take breaks and rotors still spinning while the PTO has stopped. Operator's awareness is the key to safety around rotating parts. Do not raise the machine while the blades are rotating.

Risk of ejecting objects

Machines that mows throws out material while driving. Foreign objects such as rocks, sticks and other debris can get into the machine and ejected with tremendous speed. Cover the sides and the front prevents these objects to be thrown out but it does not always guarantee that the guards catch everything that is thrown out.



Bystanders or animals that stand in the way of the projected object can be seriously damaged. Never bystanders within the vicinity of the machine. Respect the machine's danger zone. **Danger zone 15m!**

Noise

Please note that the machine is normally used outdoors and that the position of the operator is in the driving seat of the tractor. It is advisable to read the regulations specified in the tractor manual and maintenance instructions.

The sound pressure level exceeds 70 dB during operation. Hearing protection should be used while driving.

Accidents involving slips and falls

Accidents involving slips and falls often happens as the result of:

- Slippery surface
- Uneven steps and platforms

The potential for slip-and-fall accidents can be significantly reduced by using good judgment. All unprotected rotating machinery is a potential for accidents. Damage usually occurs when loose clothing or long hair caught and wrapped around rotating parts such as transmission shafts or drive shafts on the machine. Make sure all guards are fitted.

Drive safely on public roads

Always follow traffic safety on public roads and follow the rules applies for driving tractor with towed equipment gear on public road.

Make sure reflectors, warning and / or warning flag that indicates protruding equipment is mounted on the machine or tractor. These indicators must be installed properly and must be visible and easily seen by the driver of the second vehicle.

Spectators must not lean on or climb on the machine during transport or during work.

NEVER allow anyone to ride on the machine!

The maximum transport speed should not exceed 20km /h

SETTING OF DRAWBAR

Drawbar coupling height of the towing vehicle may vary. To customize the settings, there is a screw rod in the drawbar which can be extended or shortened so that the mower is horizontal with the ground. (This brings the more efficient mowing).

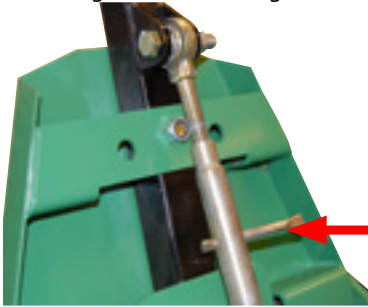

Turn/rotate the lever, extend the lever to raise the drawbar or shorten to lower it.



Move the position of the tow bar by disassembling the turnbuckle mounted under the drawbar, move the draw bar to the desired position.

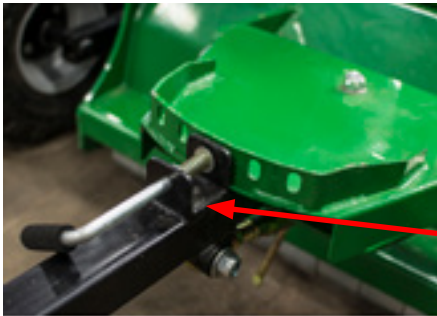

Pull out the shaft and move to the desired angle.



RETIGHTEN BOLTS AFTER SOME HOURS DRIVING!!!

START THE ENGINE

- Read and understand the engine manual before using the machine.
- Observe all safety precautions: Keep hands and feet away from blades and other moving parts.
- Ensure that bystanders are at a safe distance from the machine.
- Ensure that there is space between the blades and ground / grass before starting the engine
- Choose an area free from loose objects that can be thrown around.
- Turn on the engine choke and control the idle throttle.
- Place one foot on top of the machine to get a firm grip and good balance. Pull the starter rope; follow slowly with the rope back to the engine.
- After a few minutes of warming the engine at idle, set the throttle to the factory settings for work so as to give the engine a normal working speed of up to 3600 revolutions.

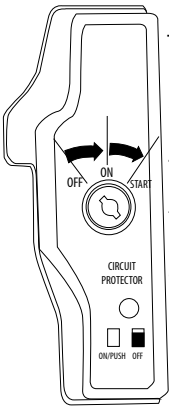

Turn on the choke and put the throttle on idle

1. Check the oil and fuel level before starting the engine.
2. Open the fuel valve.
3. Put the throttle on "run"
4. Turn the key to "Start"
5. Let go of the key as soon as the engine starts, this moves to the starting position automatically. Warning! Do not attempt to start the engine longer than 5 seconds. The "START" interval should be done every 30 seconds. Warm up the engine for 3 minutes before operation.



Caution!

If the gas is altered to exceed the speed of the given recommendations, the warranty may be invalid, and mower efficiency will decrease; the fuel consumption will increase and excessive vibrations can occur, causing danger to personnel and damage to equipment.

DRIVING AND SPEED

The amount of grass to be mowed determines the speed forward; low speed usually ensures the best results. Make sure that you have followed the following sequence. Have the normal speed of 3 km/h at heavy work, and 10 km/h at easy work. Start with the lowest possible speed, ensuring that the mower works effectively with the engine at maximum speed effortlessly. (If this is not possible due to very tough mowing conditions, increase the mowing level and mow the same area twice at a second time with a lower mowing level. Leave it for at least 24 hours between the first and second mow so that the grass can dry out.)

Increase speed forward until the engine starts moving heavily; slow immediately and hold the speed where the engine goes smoothly. It is important to always listen to the engine to ensure that the engine and mower are working effectively; slow down or stop if the engine starts moving heavily.



Caution!

When driving from normal work of the heavier mowing, it is normal that the engine runs heavy and the turning speed get slower. When this happen **SLOW DOWN IMMEDIATELY** so that the engine can resume the normal speed. Follow the instructions above at "Normal speed". Expect speed is much lower in hard work.

FAILURE OF THESE MAY RESULT IN POWER TRANSMISSION SLIP, AND VERY SERIOUS DAMAGE AT COUPLING AND DRIVE BELTS



The support skids shouldn't rest or be drag onto the ground, the skids are there to support the machine over obstacles like large rocks or mounds. If the skids are resting on the ground during operation, you can get soil/ground damage and deep grooves if flails hit the ground.

AFTER USE

- Parking is not allowed with the equipment above ground, but with the equipment resting on the ground.
- Rinse the implement if necessary.

TRANSPORT MODE

When the mower is moved from one operation to another, it is advised to raise the deck to the highest position, use the screw jack (see section mowing height). The engine must be turned off and the blades stopped before adjusting to the transport position. Remove all debris or grass etc. from the mower before you leave the field. Never move from one place to another whilst engine is still running. Please consider that flail mower is not legal on public roads and it shall not be used on public roads. Maximum speed when driving is 30km / h.



adjust the height of the machine by turning the jack.

TRANSPORTATION AND STORAGE

Make sure there are no people, children and foreign objects around the area before transporting the machine. Always take an extra caution during the transport. Ensure that the product is well secured and that transport brackets are mounted. Always place the load as low as possible. Respect the danger zone even during transport. When lifting the equipment, never go underneath suspended loads. Trailer used for transport should have working brakes.

Always store the machine in a dry place preferably underneath a cover when not in use. Ensure that the product is stable and not likely to tip over. Never let children play where the machine is being stored. Always keep in mind the risk of tipping!

MAINTENANCE AND SERVICE

Make sure that the unit is stable and not likely to tip over during service and maintenance. Replace damaged and worn parts immediately to reduce the risk of injury. Perform maintenance, servicing and inspections as recommended. Use only parts with equivalent performance to reduce the risk of damage and failure. All repairs and connections with electricity must be performed by an authorized person. Check that all nuts and bolts are tightened after maintenance and service. Always test the machine before work is started.

- Regularly check the condition of the equipment before the failure occurs.
- When cracks, twisting, bending, glitches or fatigue are detected, stop the work and correct the defects. Worn parts should be replaced.
- Retighten all nuts and bolts after a few hours of driving, or after daily run.
- Avoid using the equipment at temperatures above + 30C.
- Disconnect the equipment from the towing vehicle when repairing errors.
- Check that all nuts and bolts are tightened after maintenance and service. Always test the machine before starting.
- Lubricate moving parts regularly. For maintenance of the engine, see separate manual.

For spare parts: Contact Kellfri Service

SERVICE INTERVALS / MAINTENANCE

Check oil level before each run. Change the oil regularly in a range of about 100 hours

SERVICE	INTERVAL	
Flail	Before each run	Replace any defective flails. Sharp flails gives better results. When replacing bolts are tightened securely.
	While driving	Listen for noises
	After each run	Check
Engine oil	Before each run	Check level: 0.8L Oil type: SAE 10w-30
	10 hours	First oil change
	100 hours or once a year	Oil Change
Rotor	20 operating hours	Lubrication
Belt	Before each run	Belt tension. When pressing the belt must be moved 20 mm.
The machine	After each use	Rinse the machine from dirt or soil

TROUBLESHOOTING	MEASURE
Slope mower mows uneven or badly	Check that the flails are intact and firmly seated. Adjust the support roller and make sure it is correct. Check and tighten any belts
Cut sound changes	Check roller. Check the tension of drive belts. Check flails.
Vibrations	Check flails

INSPECTION

It is very important to regularly check the machine, in order to detect and prevent wear, tear, damage, etc.

INSPECTION OF OIL LEVEL IN ENGINE

When your mover is placed horizontal, open the oil filler cap and make sure that the oil level is up to the edge - see illustration

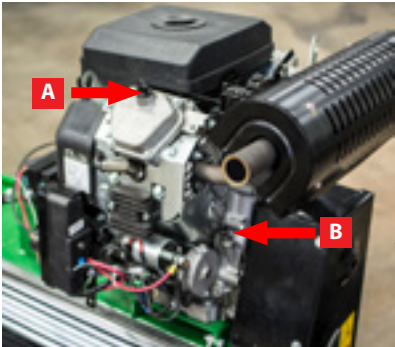

- 1. Open the filler cap (A)- top up
- 2. Check oil level with the dipstick (B)

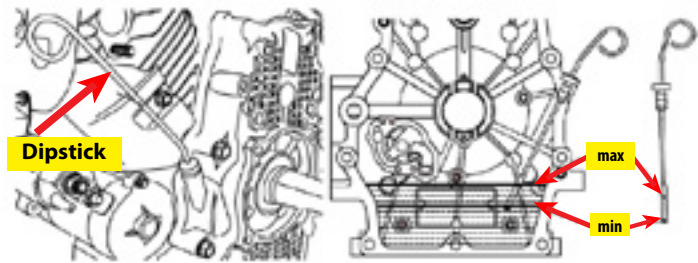

INSPECTION OF V-BELT

Initial test and post-tensioning shall be made after 1 hour of run time to be sure that the belt is properly tensioned. Check V-belt regularly and tighten as necessary. Belt tension at pressure belt should be moved 20 mm (10 mm on each side).

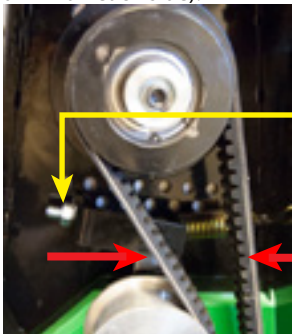

NOTE! When lubricating the drive shaft: be careful not to pump too much grease. Excessive grease can cause the belt to slip and burn. Remove the protective cover over the belts for full view of lubrication points. wipe excess rease when necessary. Lubricate regularly!

INSPECTION OF ROTOR BEARINGS

Spin the rotor shaft by hand and feel any irregularities in the bearings. Moreover, try to move the axle from side to side to detect any gaps. If either or both of these occur, remove the axle caps to closer inspect the bearings. Replace if necessary

INSPECTION OF WHEEL BEARINGS

First make sure that all the wheel nuts / bolts are securely tightened; Jack up one side of the mower so that one of the wheels is just above the ground. Spin the wheel by hand and check the wheel placement. In order to check bearings, try to move the wheel from right to left to feel any gap. Replace worn bearings.

GREASE 50MM TRACTION COUPLING

Check the link to see signs of damage or wear, spin coupling 36 degrees and check if the bushings are not worn. Replace damaged and / or worn parts. Lubricate the coupling regularly.

MAINTENANCE OF KNIVES

The mower is equipped with knives made to last for a long time. If the blade becomes loose or broken, it is important to replace it immediately. If there is a possible imbalance, which is very serious, then the blade should be changed and the blade on the opposite side of the rotor must be controlled for current damage and wear. If it is partly or completely worn out, it should be replaced to maintain the correct weight balance. When the first edge is getting blunt, the whole set should be reversed or replaced. Using dull blades will reduce the cutting efficiency and increase fuel consumption. Replacing the blades is instructed as follows:

- A) Ensure that the engine is off and the blades are not rotating. Turn off the fuel valve and allow the engine to cool for five minutes. Remove the spark plug to make sure the engine does not start.
- B) Raise mower to its maximum cutting height.
- C) Raise gently the drawbar to a slightly inclined position so that the height adjustment hinge may bear some weight.
- D) Loosen and remove the bolts.
- E) Replace the blades (note the direction of rotation).
- F) Replace the bolts properly, and check that if the blades can move on the shaft.

Never use worn, cracked or repaired shackle when the blades are reinstalled. Replace with new ones. For repairs beyond those previously listed adjustments, please contact your local dealer.



WARNING!!

Never install different types of flails on the mower. When replacing flails, always check the tightening of the screws. Make sure all screws are properly tightened.

SUPPORT ROLLER AND SIDE RAILS

The main purpose of the support roller and side rails is to prevent damage. If one wheel goes into a hole, or if the ground becomes uneven between the wheels, the roll will bear the mower's weight and thus prevents the blades from hitting the ground. The support roller in combination with side rails offers the rotor protection. The support roller has the additional advantage of enabling edge mowing of the grass since the roll allows the wheels to hang off the edge. The factory-set position of the roller and side rails are suitable for most situations. However, if the mower is widely used in tougher terrain, the roll and side rails can be lowered; thereby providing increased ground clearance for rotor and blades. At the positions, mower is used to "fine tune" so that the roll can be increased by using the desired mowing height given by the various holes and the wheels can then be lifted off the ground.



Adjust the skid rails to the desired height, when adjusting the skids make sure you adjust the roller as well.

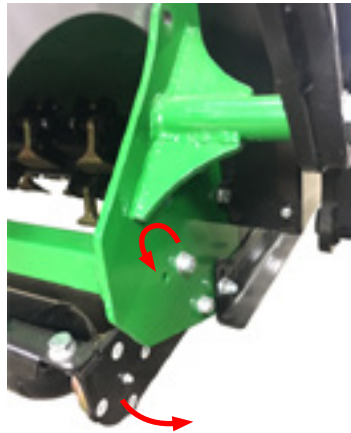

Adjust the angle of the roller by moving the bolts (marked on the figure)

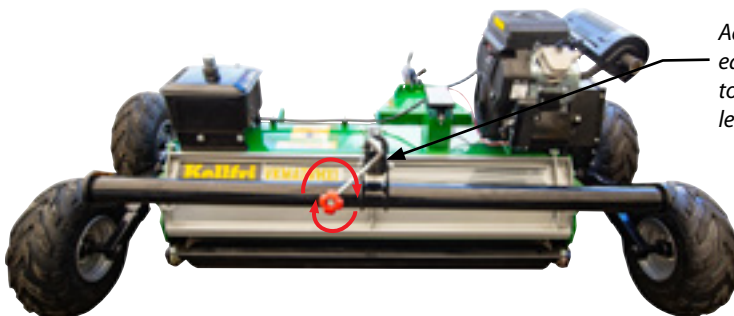

Adjust the cutting height easily by turning the jack to the right to raise and left to lower

ASSEMBLY

The machine is delivered partially assembled. **CAUTION!** The machine is heavy! It is recommended that the assembly is carried out by 2 persons. Lifting device may be required. Risk of crushing!

1.) Remove the transport crate and remove all parts packed together with the machine

1x - cutting unit with motor

2x - Boggie with 2 wheels (right and left)

1x - Towing bar

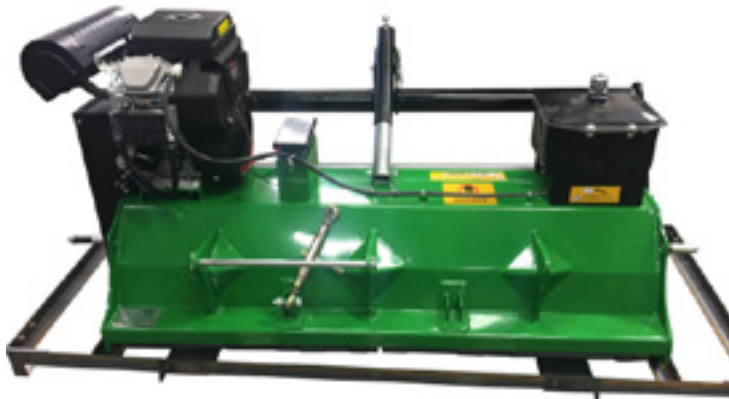

(fig. 1)

NOTE! Bolts etc are mounted onto the machine.

2.) Remove nuts that are located on the wheel axle (right and left side, then install both wheels. Note: The sleeve (Fig. 2) must be mounted on the outer side of the boogie. Important! Install the wheels correctly. The wheel tracks should point towards the driving direction, there's an arrow on the wheel that shows the direction of wheel rotation.



fig. 2



3.) The drawbar can be mounted in different positions: in the center of the cutting unit straight behind the ATV or move the drawbar to the left for cutting aside. Choose the desired cutting position and install the drawbar. Note The turn buckle (Figure 4) must be mounted under the drawbar. Remove the shaft and mount the drawbar, lift the drawbar assembly (Fig. 5), mount the turn buckle and tighten the bolt (he turn buckle may need to be extended for easier assembly).

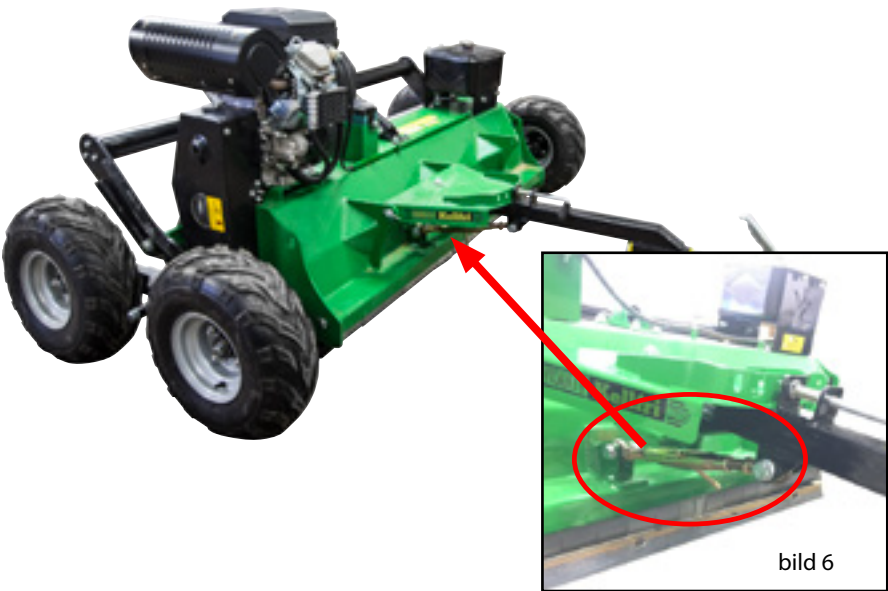
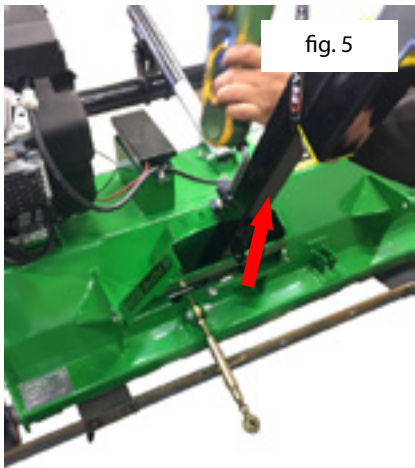

RECYCLING

When disposing of the tool be disassembled and transported to the municipality destined place. Contact your local authority for further information.

MACHINE ASSEMBLY

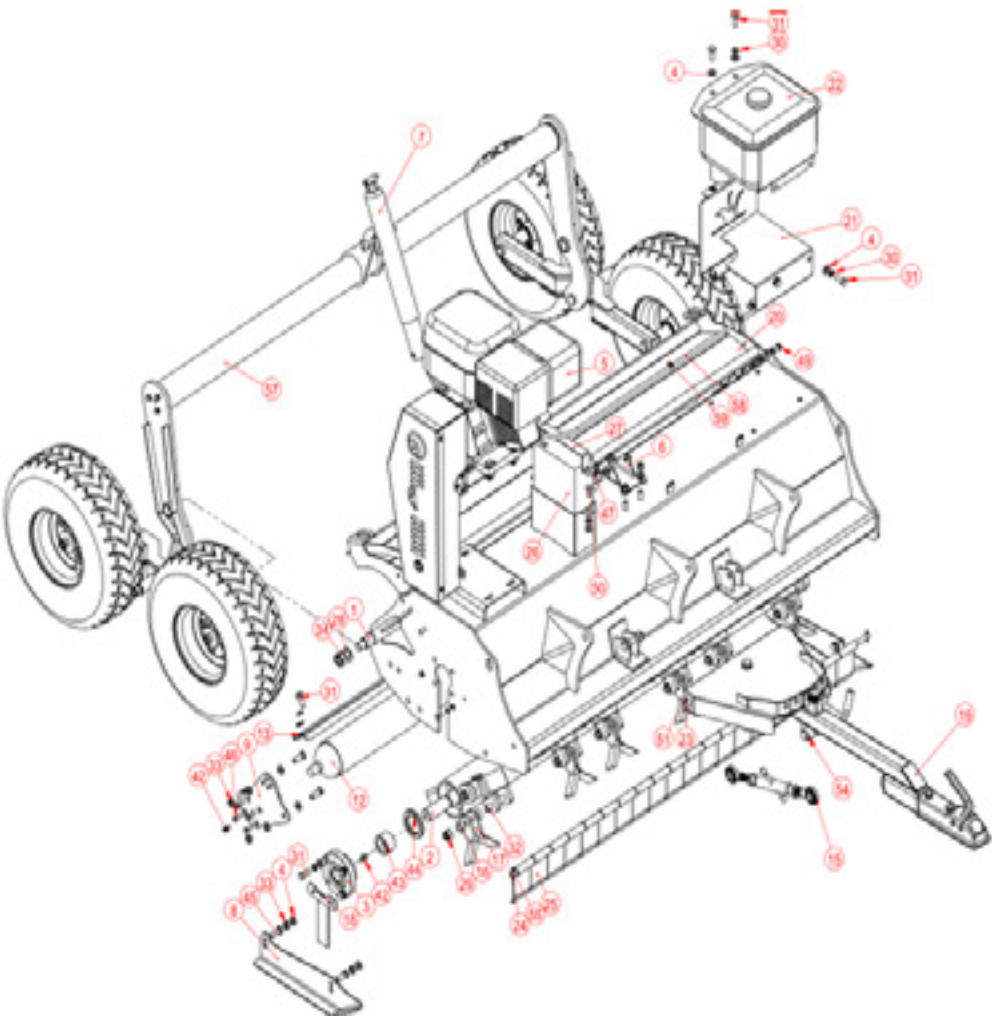

No.	DESCRIPTION	QTY
1	machine cover welding	1
2	cutter shaft welding	1
3	UC207 bearing with housing	2
4	plain washer	40
5	driving system	1
6	support plate	1
7	10cun	1
8	right skateboard	1
9	adjustable plate (right)	1
10	adjustable plate (left)	1
11	UC205 bearing with housing	2
12	roller	1
13	scraper	1
14	left skateboard	1
15	adjust pull rod assembly	1
16	(Y) blade spacing	48
17	big Y blade (or hammer)	48/24
18	plate welding	1
19	connecting arm assembly	1
20	back cover welding	1
21	fuel tank welding parts	1
22	fuel tank	1
23	shaft	1
24	damper shaft	1
25	damper	20
26	battery (large)	1
27	battery locking plate	1
28	plain washer 39*24*3	2
29	hexagon locking nut M16	24
30	spring washer 12	18
31	hexagon bolt M12x30	20

No.	DESCRIPTION	QTY
32	hexagon bolt M16x90	24
33	hexagon locking nut M12	13
34	hexagon locking nut M20	2
35	plain washer 8 16*9*1.6	2
36	spring washer 8	2
37	hexagon bolt full thread M8x20	2
38	big washer 30*11*2.5	6
39	plain washer 20*11*2	7
40	hexagon bolt M10x50	4
41	hexagon locking nut M10	9
42	lubrication point M8-1	4
43	sleeve	1
44	oil seal 80x55x10	1
45	hexagon bolt M12x35	8
46	inner hexagon head screw M8x25	8
47	hexagon bolt full thread M12x90	1
48	plain washer 20*11*1	3
49	hexagon bolt M10x30	3
50	hexagon bolt M10x25	2
51	split pin 5x40	2
52	plain washer 17.5*30*3	2
53	locking nut M16	2
54	hexagon bolt M16x70	2
55	split pin 4x25	2
56	plain washer 12x1	20
57	wheel assembly 12	1
58	gasoline pipe	1
59	hose clamp SPR	2

DRIVING SYSTEM ASSEMBLY

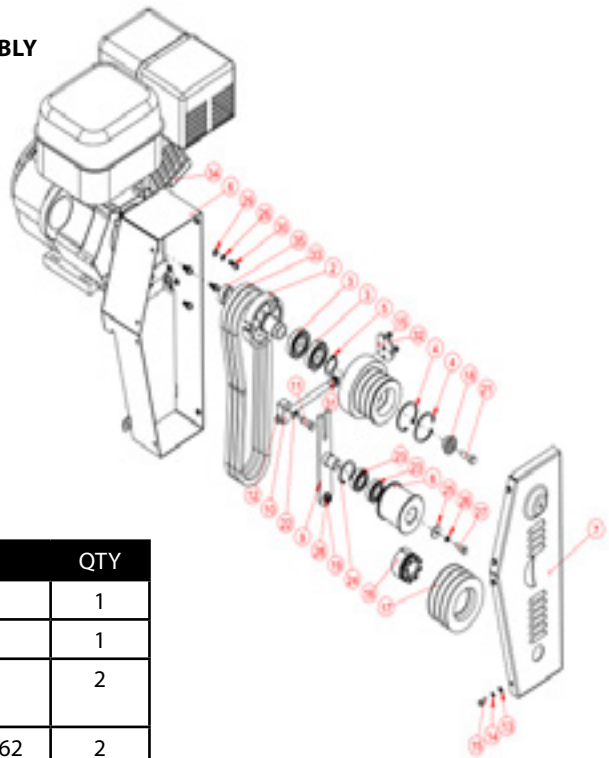

No.	DESCRIPTION	QTY
1	driving pulley	1
2	clutch	1
3	deep groove ball bearing[60000-2Z]	2
4	circlip for hole A type 62	2
5	circlip for shaft B type 35	1
6	pulley cover welding	1
7	cover	1
8	tensioning wheel	1
9	tensioning wheel bracket welding	1
10	latch segment	1
11	locking pin	1
12	M14 threaded rod	1
13	plain washer 12*6.5*1.6	9
14	spring washer 6	10
15	hexagon bolt M6×16	9
16	Taper -lock 60-35	1
17	driven pulley	1
18	fixed part for driving pulley	1
19	plain washer 30*11*2.5	2
20	spring washer 10	1

No.	DESCRIPTION	QTY
21	hexagon bolt 3/8-24*35	1
22	split washer 9	1
23	deep groove ball bearing[60000-2Z]	2
24	circlip for hole A type 47	1
25	large washer 28*9*3	1
26	spring washer 8	5
27	hexagon bolt M8x25	1
28	hexagon locking nut M8	1
29	plain washer 8	4
30	inner flat head screw M8x20	4
31	ball bearing 51100	1
32	pressure plate	1
33	BX1067	3
34	double-cylinder engine	1
35	spacer for clutch	1

WHEEL ASSEMBLY

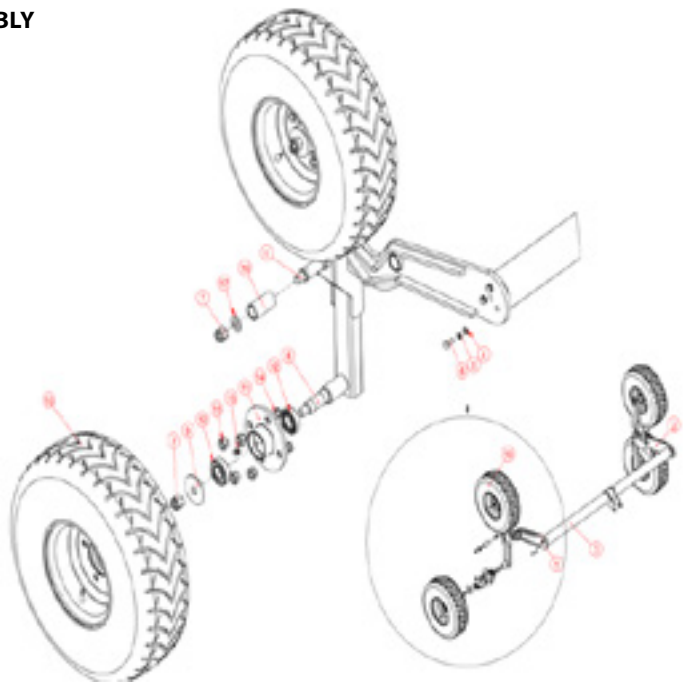

No.	DESCRIPTION	QTY
1	wheel arm welding(right)	1
2	wheel arm welding(left)	1
3	connecting pipe welding	1
4	plain washer 8 16*9*1.6	6
5	spring washer 8	6
6	hexagon bolt M8×20	6
7	hexagon locking nut M16	6
8	double bridge	2
9	gasket	4
10	wheel	4
11	wheel flange welding	4
12	deep groove ball bearing 6205-Z	8
13	grease fitting M8×1	4
14	bolt M12X37	16
15	special nut M12	16
16	shaft cushion covers	2
17	plain washer 17.5*30*3	2

TOWING BAR ASSEMBLY

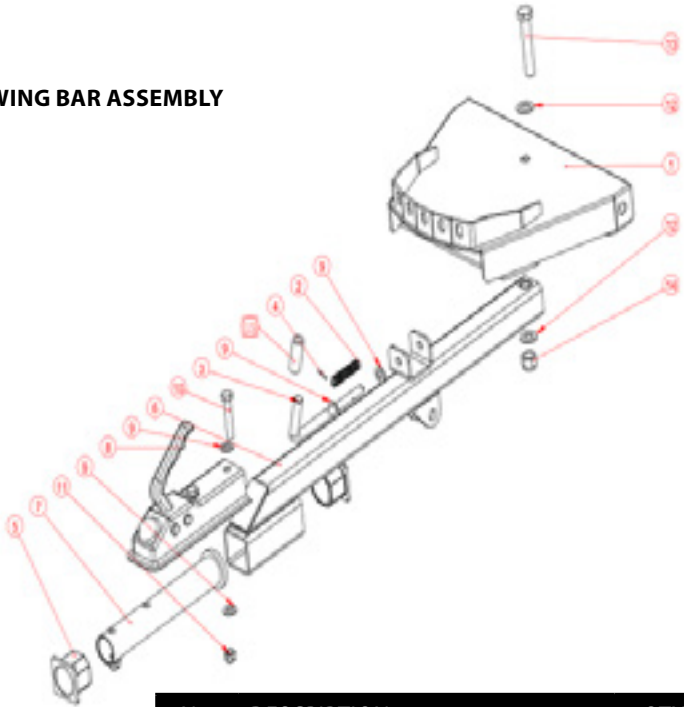

No.	DESCRIPTION	QTY
1	traction panel welding	1
2	compressed spring	1
3	shake handhandle	1
4	elastic cylindrical pin 3×22	1
5	sleeve	2
6	traction square tube welding	1
7	joint pipe welding	1
8	trailer coupler	1
9	plain washer 12	6
10	hexagon bolt full thread M12×65	2
11	hexagon locking nut M12	2
12	plain washer 16	2
13	hexagon bolt M16×85	1
14	hexagon locking nut M16	1
15	glove 11*55	1

COMPLAINT FORM

We are grateful for your help pointing out any inaccuracies in the Kellfri product delivered to you. Before making a complaint read Kellfris general warranty and sales conditions in our catalog as well as the enclosed User's manual that comes with the machine.

Please fill in the details below and attach photo and other information in order to process your request.

Buyer:	Customer number:
Adress:	Invoice number:
E-mail:	Phone nr:

When was the product delivered?	When was the product taken into operation?	Did the product functioned as it should upon the first operation?
--	---	--

Defect product / part:
.....

Problem description:
.....
.....

Describe the sequence of events:
.....
.....
.....
.....
.....
.....

Other:
.....
.....

Submit Complaint form and photo to:
Kellfri AB
Division of Services : Contact Kellfri retailer
Or e-mail service.
info@kellfri.se

Signature:	Date:
------------	-------

WARRANTY TERMS AND CONDITIONS

Validity of the warranty	- Kelifri's Warranty is valid 12 months from the date of purchase.
This warranty replaces	- Compensation for spare parts after acknowledgment that the fault lies on the material or manufacturing defects.
This guarantee do not cover	<ul style="list-style-type: none">• Labour costs• Travel expenses• Any modification that the buyer himself has/had made.• Any consequential damages that occurred due to damage to the machine.• Damage due to normal deterioration of the machine, inadequate: service, user inexperience or use of spare parts which are not original.• Wear parts such as hoses, seals, oils, and mechanical belts

EC-DECLARATION OF CONFORMITY, ORIGINAL



According to 2006/42/EC, Annex 2A
Kelffri AB
Munkatorpsgratan 6
532 37 Skara, Sweden

Declares that the machine

Name: 35-VKMATV150HXL

Type: Flail mower ATV

Complies with all applicable provisions of the Machinery Directive 2006/42/EC.
Other equipment must meet the hardware requirements of the Directive.

Kjell Johansson
Product Development Manager

CUSTOMER SERVICE

*You are always welcome to give your feedbacks, reviews or ask us about our equipment and products.
Kelffri AB is constantly working on further developing their products and therefore reserves the right to modify, among other things the design and appearance without further notice.*