



# **Kellfri<sup>®</sup>**

## **16-TGR835E**

## **16-TGR835T**

# **TIMBER GRAPPLE FOR FRONTLOADERS**



CAREFULLY READ THE OPERATING INSTRUCTIONS BEFORE USING THE PRODUCT!  
OPERATING INSTRUCTIONS TRANSLATED FROM THE ORIGINAL

**INTRODUCTION**

Thank you for choosing a product from Kellfri AB. By following the general safety information and the instruction manual and by using common sense, you will have a great and safety use of your Kellfri product for many years.

Kellfri designs and delivers effective, affordable machinery and components for forest, agriculture, construction and gardening in Sweden, other Nordic countries and Europe.

**PRODUCT INFORMATION**

Hydraulic timber grapple for front loader, makes it easy to manage, logs, firewood, bushes and more. Durable metal beam at the bottom and thoughtfully designed for great visibility and geometry. Delivered with hydraulic hose with 1/2 inch male quick coupler. Trima or Euro bracket.

**INTENDED USE**

For loading logs, firewood, bushes etc.

TECHNICAL DATA	16-TGR835T	16-TGR835E
Distance between claws	770 mm	770 mm
Weight	185 kg	185 kg
Max opening	715 mm	715 mm
Cylinder	80/40-220	80/40-220
Gripping area	ca 0,4m <sup>3</sup>	ca 0,4m <sup>3</sup>
LxWxH	800x1000x715mm	800x1000x715mm
Linkage	Trimma	Euro

## FOR YOUR SAFETY

Before using the product, please read the safety information and instruction manual and understand its contents for your own and others' safety. Always keep the safety information and instruction manual easily accessible to the user of the product. Remember that it may be good for your own and others' safety to read the safety information every now and then. If the instructions manual is damaged or otherwise unusable, please contact your retailer.

For more information visit our website: <https://www.kellfri.co.uk/>

Do not use this equipment if you are feeling sick, tired or in influence of alcohol. Nor if you are under the influence of strong medications or drugs, suffering from strong depression or severe mental illness. Always follow the general traffic rules and regulations and the rules of the Animal Welfare Act. Persons under 15 years old and people with mental illness may not use these product.



**Warning symbols identify important safety aspects in this manual to help you and others avoid hazards and accidents. When using the machine: Be extremely careful!**



This symbol indicates that a serious accident will occur if the instructions in the manual are not followed. The accident leads to serious injury, possibly death or serious property damage.



This symbol indicates that an accident will occur if the instructions in the manual are not followed. The accident leading to serious injury or property damage.



This symbol indicates that an accident may occur if the regulations are not followed. The accident results in personal injury or property damage.



N.B! indicates the potential of failure if the regulation is not followed.

## PRODUCT SAFETY INFORMATION

- The load can drop uncontrollably if the machine is overloaded . The equipment is always operated from the driver seat of the tractor. Never leave the tractor before the equipment is unloaded and the tractor braked.
- Respect the implement's risk zone.
- Warning of crushing risk! No one other than the operator may be present within the risk zone during work. Operator or other person must never be under the load.
- N.B! Never overload the machine. Check the front linkage maximum lifting capacity!

## IN CASE OF EMERGENCIES

In case of an emergency please dial 112.

Keep cell phone or emergency phone available specially when working alone. First aid kit and fire extinguishers must be kept easily accesable during all work, maintenance and service.

## SURROUNDINGS

Make sure your working area is clear from people, children and objects before installing and using the machine. Risk of serious injuries can occur during operation.

Take an extra caution when children are in the area where the equipment/ product is being use or stored. Check the area for low hanging electrical wires. Be careful when working on slopes and near ditches.

Always work alone with single - purpose tools/products. Never have junk lying in your area. Keep working areas clean. Always respect the risk zone.



**WARNING SIGNS AND LABELS**

Ensure that warning labels are always visible and clean. Clean the warning labels as required. Do not rinse using pressure washer directly on the warning labels. Any damage/ broken stickers should be replace. Order new stickers from your supplier.

	Read the operating manual! Before carrying out work Warning! Before maintenance, servicing, connecting and disconnecting the machine, the tractor must be turned off and the ignition key removed.
	Warning! Do not permit anyone to stand under suspended loads
	Warning! Risk zone 5m
	Danger! Accident risk for children!
	Warning! Keep off the machine!
	Warning! Risk of crushing!

**PERSONAL PROTECION**

Always use suitable protection equipment. Do not wear loose clothing or jewellery while working with the equipment. Long hair should be tied up when working with equipment that has moving parts



## SAFETY MEASURES BEFORE OPERATING

Read the safety information and instruction manual carefully. Be sure you understand the safety measures, instruction manual and warning labels. Use common sense when operating the machine and use appropriate personal protective equipment.

Always check the performance and the machine combination that are used. It's highly important that these matches in a satisfactory manner. This is to ensure the product or the function and most important yours and others safety. Do visual inspection of equipment or product before use. Fix or replace damaged or worn parts immediately to reduce the risk of injury. Lubricate moving parts and check that all screw-nuts and bolts are tightened. Learn and remember the correct working methods. Beginners should always keep a low speed, use extreme caution before routine and product knowledge is achieved. The user/customer is responsible to handle the situation correctly. The product should not be taken into use unless it can be done in a safe way for the user.



## OPERATING THE MACHINE

Only people who understand the safety information and instruction in this manual are allowed to operate this equipment. Be alert and cautious while working with the equipment and only use the equipment in the way it is described in the instruction manual. Avoid using the machine at temperatures lower than -20 ° C and higher than 30 ° C. When working with equipment that has moving parts, there is always the risk of injury. Be careful when working with equipment equipped with hydraulic hoses ,oil under pressure can penetrate the skin. Seek medical attention immediately if this occurs. Always work alone with the tools that are defined as single purpose tools. Respect the equipment's danger zone.

A hydraulic system is never 100% tight. A hydraulic controll should always be performed before the tool is loaded. Leakage may be due to internal leakage in the tractor's valve, an electric valve on the front loader, internal leakage in the implement hydraulic cylinder mm. Check the extent of the leak by running the implement cylinder in end position and keep up the pressure for 1 min. If the cylinder begins to "wander" in the other direction is a leakage of the gasket. Gasket or cylinder should be replaced.

Always work alone with the tools that are intended for it. Never overload the implement and respect the implements risk zone.



## CONNECTING AND DISCONNECTING

Read the Timber grapple for frontloaders manual before mounting it to the tractor. The implement is connected to the tractor's frontloader then secured with locking pins. Connect the hydraulic hoses to the tractor's hydraulic outlet.

### CONNECTING

After connecting the implement ensure that the grapple is properly locked by pressing the tool gently into the ground and make sure it does not come loose.

1. Make sure that the lever on the quick coupler is in vertical position.
2. Move the lever forward so that the hooks on the top of the equipment is higher than the bar of the quick coupler.
3. Raise the loader's arm so that the bar falls below the hooks on the tool.
4. Then tilt the loader as far as possible , so that the hooks locks in .
5. The the quick release lever should automatically move into its locking position.
6. With lever and quick connector in horizontal position, check that the loader is correctly coupled with the lower holes of the bracket on the attachment .
7. Do not forget to install the locking pins.

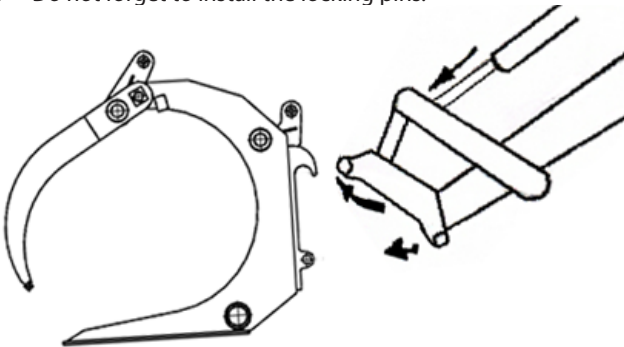

### DISCONNECTING

1. Lower implement to the ground. Remove locking pins.
2. Move the quick coupling from horizontal position to vertical position to release the tilt mechanism. The lever stops in the position automatically .
3. **WARNING!** Stand on the right side of the loader, never stand in front of it during the coupling and uncoupling of the implement.
4. Drive the tractor slowly backwards while lowering the front of the quick connector to free the bar from the hooks of the implement

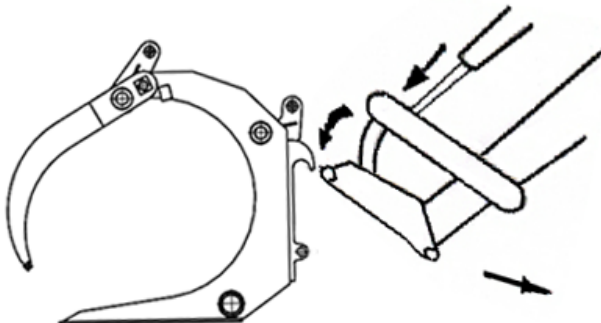

## AFTER USE

Parking is not allowed with load above ground . When parking with load the implement should be lowered to the ground. Rinse the implement with water if necessary.

## STORAGE

Always store the machine in a dry place preferably underneath a cover when not in use. Ensure that the product is stable and not likely to tip over. Never let children play where the machine is being stored. Always keep in mind the risk of tipping!

## MAINTENANCE AND SERVICE

Visually inspect / control the implement and its equipment regularly. The tractor engine must be switched off and the implement should be lowered to the ground state before working with the service begins. Make sure the tool is stable and not likely to tip over during maintenance and service. Replace damaged and worn parts immediately to reduce the risk of injury. Lubricate all moving parts and grease nipples and check hydraulic hoses regularly. The hydraulic system is not adapted to the environmentally friendly oil. Only use parts with equivalent performance to reduce the risk of damage and failure. All repairs and connections of electricity must be carried out by persons with the relevant knowledge. Check all bolts and nuts are tightened after use, maintenance and / or service. Always test the machine before work is started.

## RECYCLING

Disposal of the product, disassemble and transport to the municipality's recycling station. Contact your local authority for further information.

### Hydraulic diagram gripping cylinder

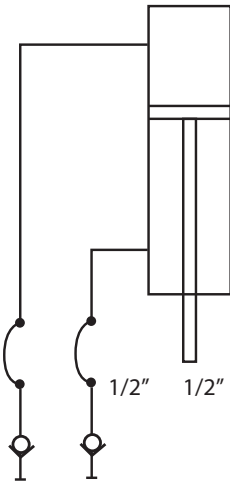



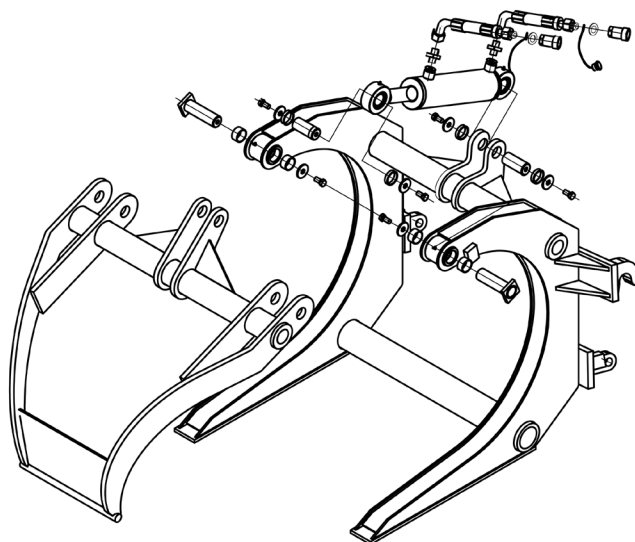

**Timber grapple for front loader with Euro hitch**

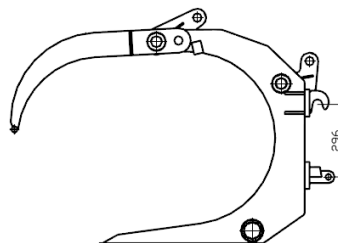
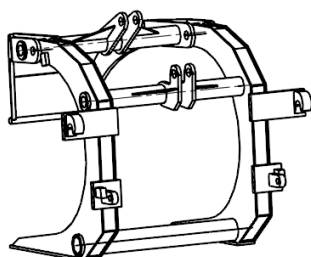
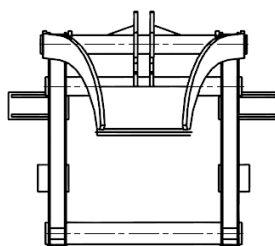
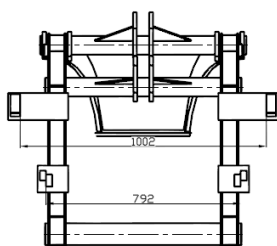

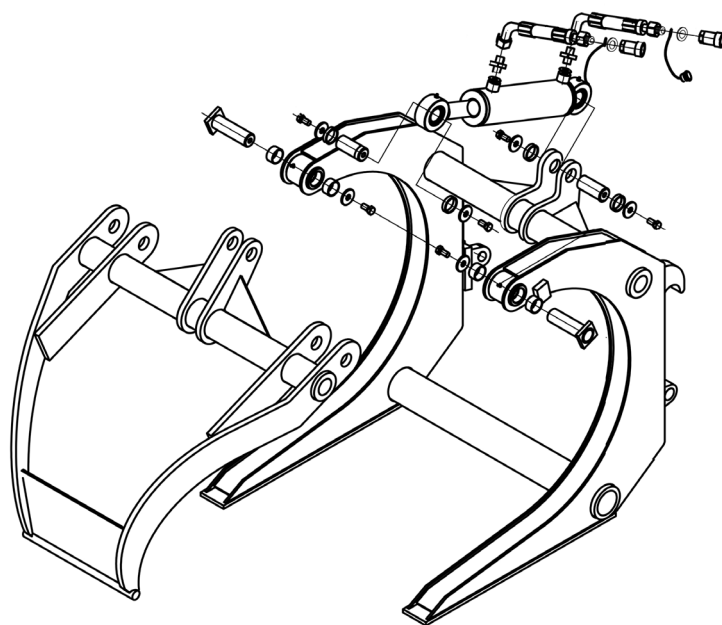

**Timber grapple for front loader with Trima hitch**

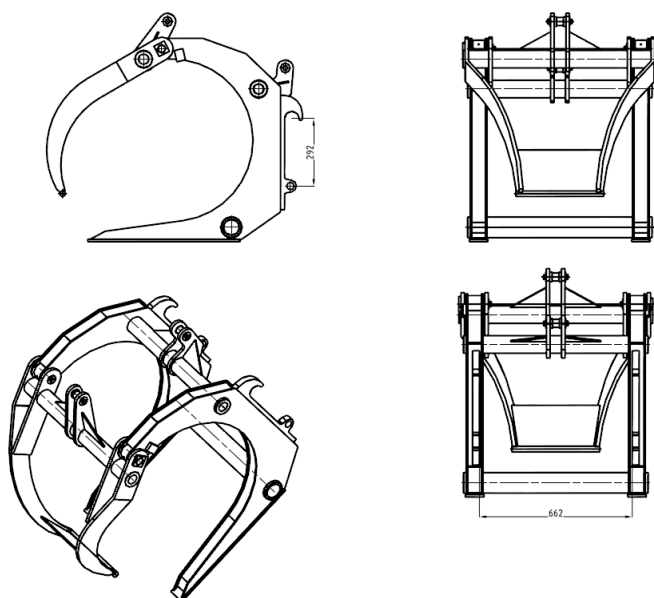

We are grateful for your help pointing out any inaccuracies in the Kellfri product delivered to you. Before making a complaint read Kellfris general warranty and sales conditions in our catalog as well as the enclosed User's manual that comes with the machine.

Please fill in the details below and attach photo and other information in order to process your request.

<b>Buyer:</b>	<b>Customer number:</b>
<b>Adress:</b>	<b>Invoice number:</b>
<b>E-mail:</b>	<b>Phone nr:</b>

<b>When was the product delivered?</b>	<b>When was the product taken into operation?</b>	<b>Did the product functioned as it should upon the first operation?</b>
--	---	--

**Defect product / part:**

.....

**Problem description:**

.....

.....

**Describe the sequence of events:**

.....

.....

.....

.....

.....

.....

.....

**Other:**

.....

.....

*Submit Complaint form and photo to:*

*Kellfri AB*

*Division of Services : Contact Kellfri retailer*

*Or e-mail service.*

*info@kellfri.se*

<b>Signature:</b>	<b>Date:</b>
-------------------	--------------

## WARRANTY TERMS AND CONDITIONS

Validity of the warranty - Kelifri's Warranty is valid 12 months from the date of purchase.

This warranty replaces - Compensation for spare parts after acknowledgment that the fault lies on the material or manufacturing defects.

This guarantee do not cover

- Labour costs
- Travel expenses
- Any modification that the buyer himself has/had made.
- Any consequential damages that occurred out of damage to the machine.
- Damage due to normal deterioration of the machine, inadequate service, user inexperience or use of spare parts which are not original.
- Wear parts such as hoses, seals, oils, and mechanical belts

## CE EG-FÖRSÄKRAN OM MASKINENS ÖVERENSTÄMMELSE, ORIGINAL EC-DECLARATION OF CONFORMITY

According to 2006/42/EC, Annex 2A

Kelfri AB

Munkatorpsgatan 6

532 37 Skara, Sweden

Declares that the machine

Name: 16-TGR835E 16-TGR835T

Type: Timber grapple for front loaders

Complies with all applicable provisions of the Machinery Directive 2006/42/EC.

Tina Baudtler, VD

*Kelfri AB is constantly working on further developing their products and therefore reserves the right to modify, among other things the design and appearance without notice.*

---

### CUSTOMER SERVICE

You are always welcome to give your feedbacks, reviews or ask us about our tools and products.

Kelfri AB

Phone: +46 (0) 511 - 242 50

Fax: +46 (0) 511 - 168 33

E-mail: [info@kelfri.se](mailto:info@kelfri.se)

Latest version : 2015-06-17