

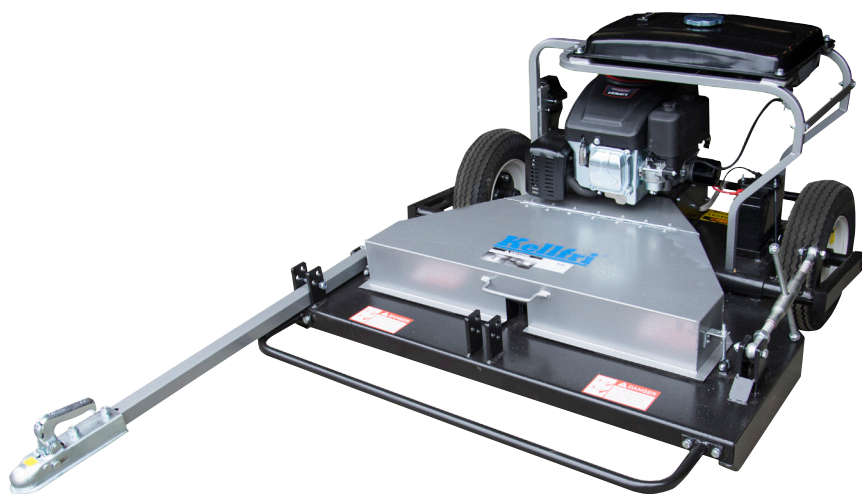

Kellfri®

35-RKATV117 ATV ROUGH MOWER



CAREFULLY READ THE OPERATING INSTRUCTIONS BEFORE USING THE PRODUCT!

OPERATING INSTRUCTIONS TRANSLATED FROM THE ORIGINAL

TABLE OF CONTENT

Product information	3
Technical data	3
For your safety	4
Product safety information	4
In case of emergencies	5
Personal protection	5
Surroundings	5
Warning signs and labels	6
Before use	7
Use/operating	8
Connecting	8
Cut height - adjusting	8
Driving and speed	9
After use	9
Petrol handling	10
Transport and storage	10
Maintenance and service	10-12
Maintenance of knives	13
Service and trouble shooting	14
Spare parts	15
Assembly instructions	16-17
Exploded diagram	18-26
Complaint form	27
Warranty and EG-mark	28

INTRODUCTION

Thank you for choosing a product from Kellfri AB. By following the general safety information and the instruction manual and by using common sense, you will have a great and safety use of your Kellfri product for many years. Kellfri designs and delivers effective, affordable machinery and components for forest, agriculture, construction and gardening in Sweden, other Nordic countries and Europe.

PRODUCT INFORMATION

Kellfri Rough Mower with electric starter for ATVs/Quads. Cutting unit with generous 116 cm cutting width enables you to quickly cover large areas of grass. Three overlapping blades mean that you avoid strips of uncut grass. The cutting height is simple to adjust between 25-250 mm. Tow the rough mower at the rear or angled to the sides, works well in hilly terrain. Supplied with a 16 hp force-feed lubricated engine. Ball hitch for 50 mm tow bar included.

INTENDED USE

The equipment is intended for cutting and trimming grass or green areas.
The machine must not be run in rocky terrain.

IMPORTANT !! THE MACHINE IS DELIVERED WITHOUT ENGINE OIL!

TECHNICAL DATA	35-RKATV117
Working width	116 cm
Engine	16 Hp 3600 rpm
Battery	12V
Cutting height	25-250 mm
Ball coupling	50 mm
Dimension (Lx Bx H) cm	128x112x63
Wheel designation	4,80/4,00-8
Number of hoses.	3
Speed limit, km/h	8-10
Engine oil, type (L)	SAE 30, 10W-30 or 5W-30 see table page 12 ca: 0,7 L
Size, tank	13 L
Weight	202 kg
Spark plugs	Champion RC12YC

FOR YOUR SAFETY

Before using the product, please read the safety information and instruction manual and understand its contents for your own and others' safety. Always keep the safety information and instruction manual easily accessible to the user of the product.

Remember that it may be good for your own and others' safety to read the safety information every now and then. If the instructions manual is damaged or otherwise unusable If the instructions manual is damaged or otherwise unusable, please contact your retailer.

For more information visit our website: <https://www.kellfri.co.uk/>

Do not use this equipment if you are feeling sick, tired or in influence of alcohol. Nor if you are under the influence of strong medications or drugs, suffering from strong depression or severe mental illness. Always follow the general traffic rules and regulations and the rules of the Animal Welfare Act. Persons under 15 years old and people with mental illness may not use these product.



The product must not in any circumstances be modified without permission from the manufacturer. Unauthorized modification of the machine and/or accessories can cause fatal injuries or death to operator or others.

IMPORTANT!

PRODUCT SAFETY INFORMATION

- Never stick your hands or feet under the machine without first stopping the equipment and engine.
- Never leave your equipment with the engine running. Turn the engine off when you leave the equipment - even for a short while.
- Always disconnect the machine from the towing vehicle before performing service or maintenance work.
- Only you, who are operating the equipment, may be in the vicinity of the machine during work.
- Do not use the rough mower without all guards being mounted correctly.
- Do not turn off the engine immediately after hard work, (see, turn off the engine)
- Do not run the engine in a confined space, exhaust contains monoxide which is fatal if inhaled.
- Do not drive the mower on steep slopes.
- Clear the mowing area from harmful objects such as stones, branches, etc. before starting work.
- The machine is not designed to run on rocky terrain. Check that there are no stones on the grass surface before starting work.
- Do not try to remove things that have been stuck with the engine running. Ensure that the engine has stopped and the rotor has stopped spinning before any action is taken on the mower.
- Do not use the mower at night unless adapted spotlight is used.
- Do not drive with the mower if excessive vibration occurs, stop the machine immediately and check the maintenance schedule.
- Do not change the engine settings unless it is told by the engine manufacturer.
- Do not use the mower unless all safety precautions are taken.
- Never allow anyone to ride on the equipment!
- Do not exceed the maximum driving speed.
- **NEVER ADJUST** cutting height when the machine is running.

INCASE OF EMERGENCIES

In case of an emergency please dial 112.

Keep cell phone or emergency phone available specially when working alone. First aid kit and fire extinguishers must be kept easily accesable during all work, maintenance and service.

PERSONAL PROTECTION

Always wear suitable clothing and footwear. Do not wear loose clothing or jewelry when using the machine. Remember to put up long hair when operating rotating machines. Wear protective gloves, to prevent risking burns on contact with hot surfaces such as exhaust system, and to avoid oil and gasoline on the skin. Hearing protection should be used when the engine is running.



SURROUNDINGS





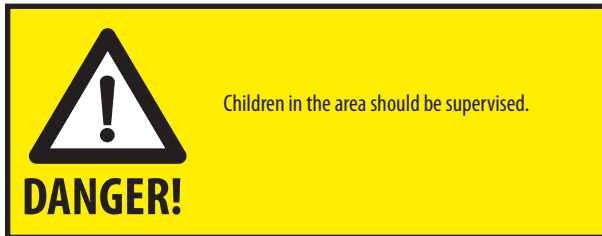

Make sure your working area is clear from people, children and objects before installing and using the machine. Risk of serious injuries can occur during operation. Take an extra caution when children are in the area where the equipment/ product is being used or stored. Check the area for low hanging electrical wires. Be careful when working on slopes and near ditches.

Always work alone with single - purpose tools/products. Never have junk lying in your area. Keep working areas clean. Always respect the risk zone.



WARNING DECALS

Ensure that warning labels are always visible and clean. Clean the warning labels as required. Do not rinse using pressure washer directly on the warning labels. Any damage/ brokenstickers should be replace. Order new stickers from your supplier.

SYMBOL	EXPLANATION	LOCATION
	Danger zone 15 m	Side of the machine
	Warning! Risk of flying debris!	
	Rotating knives	
	Fordbiden to stay on the machine.	
	Risk for children accidents.	
	The product is CE marked	

SAFETY MEASURES BEFORE OPERATING

Read the safety information and instruction manual carefully. Be sure you understand the safety measures, instruction manual and warning labels. Use common sense when operating the machine and use appropriate personal protective equipment. Always check the performance and the machine combination that are used. It's highly important these matches in a satisfactory manner. This is to ensure the product or the function and most important yours and others safety.

Do visual inspection of equipment or product before use. Fix or replace damaged or worn parts immediately to reduce the risk of injury. Lubricate moving parts and check that all screw-nuts and bolts are tightened.

Learn and remember the correct working methods. Beginners should always keep a low speed, use extreme caution before routine and product knowledge is achieved. The user/customer is responsible to handle the situation correctly. The product should not be taken into use unless it can be done in a safe way for the user.



- Ensure that all nuts, bolts and fittings are securely attached, that all gasket / transport equipment such as tape, steel tape, rope, etc. are removed.
- Make sure there is proper oil level in the engine and that there is petrol in the tank.
- Make sure there is proper tire pressure. Max 2.06 bar / 30 psi
- Ensure that all guards are in place and not come off before use.
- Check that the blades are not defective, replace if necessary.
- Check and clear mowing area from harmful objects such as stones, branches, etc. before starting the work .. The machine must not be used in rocky terrain.

OPERATING THE MACHINE

Only people who understand the safety information and instructions in this manual may operate the equipment. Be alert and careful when working with the machine and only use the tool or product in the manner described in this manual. When working with equipment that has moving parts, there is always the risk of injury. Be careful when working with equipment equipped with hydraulic hoses ,oil under pressure can penetrate the skin. Seek medical attention immediately if this occurs. Always work alone with the tools that are defined as single purpose tools. Respect the equipment's danger zone.

CONNECTING

- Plug the rough mower's ball coupling to the ATV's towing ball.
- Reduce speed when working on slopes and uneven terrain.
- Be aware that different parts of the machine may be hot after use.
- Follow the guidelines that the ATV manufacturer provides regarding towing / pulling equipment / tools.
- Be careful when you fill the tank with fuel, in particular if any parts are hot.

The rough mower is designed to make a safe and reliable job if used as instructions and for its intended use. Read and understand this manual before using the mower, if not followed, it may result in personal injury and / or damage to the equipment. When driving, always use ear protectors. During normal operating conditions, it is normally with a noise level of 83 decibels, in this case, protection recommended.

CUTTING HEIGHT

1. The mower must be turned off when adjusting the cutting height. Never adjust the cutting height with the engine running.
2. The cutting height is adjusted by turning the lever. Turn the lever clockwise to lower the knife down and counterclockwise to raise it.
3. Make sure that the mower is always kept horizontal by adjusting the handle.

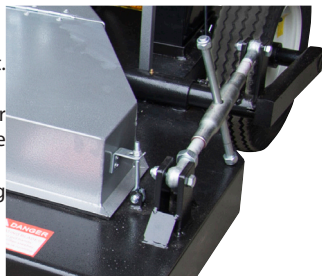

STARTING THE ENGINE

Observe all safety precautions: Keep hands and feet away from the cutting blades and other moving parts. Ensure that bystanders are at a safe distance from the machine.

1. Make sure that there is space between the blades and ground / grass.
2. Choose an area free from loose objects that can be thrown around.
3. Make sure the machine is braked and the cutting height set in the desired position.
4. Turn the fuel valve. Turn the key to "ON" position.
5. Turn the throttle. Insert the key in the ignition and press the "ON" position then turn the key to "START".
6. When the engine is cold, push up the throttle to start the shock (Picture 3).
7. If the engine does not start, press the throttle to about 1/4 and try again.
8. Always set the throttle to maximum effect when mowing or trimming grass.
6. Always warm up the engine at idle before use, in order to give the engine a normal working speed of up to 3600 RPM.



NOTE! Always turn the fuel valve off as soon as the engine is off. Make sure the "ON / OFF" switch is in the "OFF" position after each use.

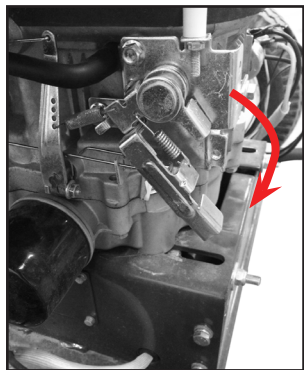

PICTURE 1

The throttle in the off mode

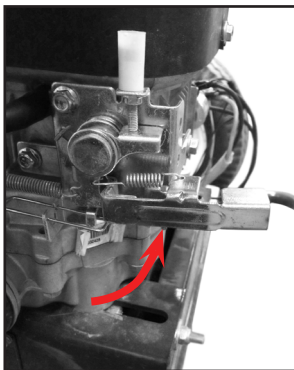

PICTURE 2

throttle - full gas

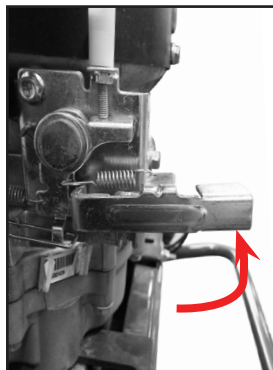

PICTURE 3

"The lever must be up additional 1-2cm" Choke mode.



WARNING!

If the gas is changed to increase the speed above the given recommendations, the insurance may get invalid. Cut effectiveness will decrease, fuel consumption will rise and large vibration can occur causing danger to the user and the equipment.

The amount of grass to be cut determines the forward speed; low speed usually gives the best result. Make sure that you follow these procedures. Normal speed 1 km / h at heavy work, 8 km / h at very light work. Do not exceed the maximum driving speed 8km / h when driving

Start with the lowest possible speed, ensure that the mower is working effectively with the engine at maximum speed without effort. (If this is not possible due to very tough mowing conditions, raise the cutting rate and cut the same surface twice, the second time with a lower cutting level, leave at least 24 hours between the first and second cut so that the grass can dry out.)

Increase forward speed until the engine begins to run slowly and heavily, then immediately decrease and hold a speed where the engine runs easily. It is important to always listen to the engine to ensure that the engine and cutter works effectively, slow down or stop if the engine starts to move heavily.

IMPORTANT! When doing normal work and then change to heavier work, it is common that the engine starts going heavy and reduces speed.

IF THIS OCCURS SLOW DOWN IMMEDIATELY so that the engine will get normal speed and velocity. Follow the instructions above with normal speed. Expected speed is much lower for hard work.

FAILURE OF FOLLOWING THESE INSTRUCTIONS will result in the power transfer slips and cause serious damage to clutch and drive belts.

TURNING OFF THE ENGINE

When the mower is turned off after hard work. Allow the engine to idle in a stationary position for at least 4 minutes, for the drive belts to be cooled down.

1. Use precaution against hot parts such as exhaust, belts, etc. after the engine is switched off.
2. Ensure that the mower's drawbar is adjusted so that it is pulled directly behind the tractor and that it is not in an odd position. When the mower has cooled down (minimum. One hour after the last use).
3. Ensure that there is no grass left on the engine cooling fins, power transmission belts and rotor before using the mower again.

AFTER USE

- Parking may not be made with the equipment suspending, but is done with the equipment resting on the ground.
- Rinse the equipment if necessary.

HANDLE PETROL WITH CARE

- Use only approved fuel containers
- Never fill the tank with fuel while it is running.
- Fill fuel tank outdoors with caution. Always fill the engine with fuel outdoors.
- Refit the fuel cap firmly and wipe any spilled fuel.

TRANSPORT AND STORING

Make sure there are no people, children and foreign objects around the area before transporting the machine. Always take an extra caution during the transport. Ensure that the product is well secured and that transport brackets are mounted. Always place the load as low as possible. Respect the danger zone even during transport. When lifting the equipment, never go underneath suspended loads. Trailer used for transport should have working brakes.

Always store the machine in a dry place preferably underneath a cover when not in use. Ensure that the product is stable and not likely to tip over. Never let children play where the machine is being stored. Always keep in mind the risk of tipping!

TRANSPORT MODE

When the mower is moved from one job site to another, it is appropriate to raise the equipment to the highest position(see section about cutting height). The engine must be turned off and the blades stopped before adjusting to the transport position may be made. Remove all loose dirt such as grass etc. from the cutter before leaving the field. Never move from one place to another with the engine running. Please take into consideration that the mower is not legal on public roads, it must not be used on public roads. Maximum speed when towing is 15km / h.

MAINTENANCE AND SERVICE

- Make sure the equipment is stable and not likely to tip over during maintenance and service.
- Replace damaged and worn parts immediately to reduce the risk of injury.
- Perform maintenance, servicing and inspections as recommended. Use only parts with equivalent performance to reduce the risk of damage and failure.

For spare parts: contact Kellfri Service

Check all bolts and nuts are tightened after maintenance and service. Always test the machine before work is started.

- Regularly check the condition of the equipment before the failure is a fact. Discovered cracks, twistings, bendings, glitches or fatigue stop work and fix the problem. Worn parts are to be exchanged.
- Tighten all screws and nuts after a few hours of driving, and after a day at every runtime.
- Disconnect the equipment from the towing vehicle when it is being repaired.
- Lubricate moving parts regularly. For maintenance of the engine, see the separate engine manual.

INSPECTION

It is very important to regularly check the machine, in order to detect and prevent wear and tear, damage, etc



LUBRICATING

Lubricate the draw coupling

Check the coupling to see signs of damage or wear.

Replace damaged and / or worn parts. Lubricate the coupling regularly.

LUBRICATE ALL LUBRICATION POINTS



Open the cover and lubricate the bearings for the strap.

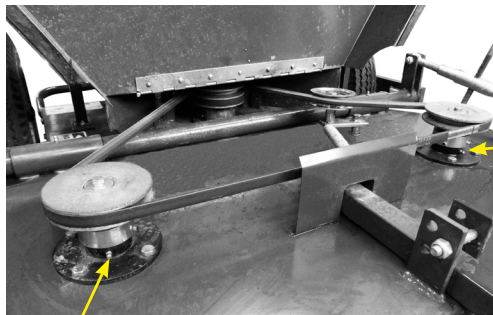

EVERY 8TH HOUR OF OPERATING:

WARNING: ENGINE MUST BE TURNED OFF BEFORE LUBRICATION IS IMPLEMENTED

Lubricate the bearings carefully, unnecessary wear and mechanical damage may result from insufficient lubrication. Use the universal lubricant.

IMPORTANT! Avoid lubricate too much. Dirt is collected in exposed fat and leads to increased wear. After greasing, wipe off excess grease from fittings.

Open the plate protection, to get to the grease fitting under the engine.

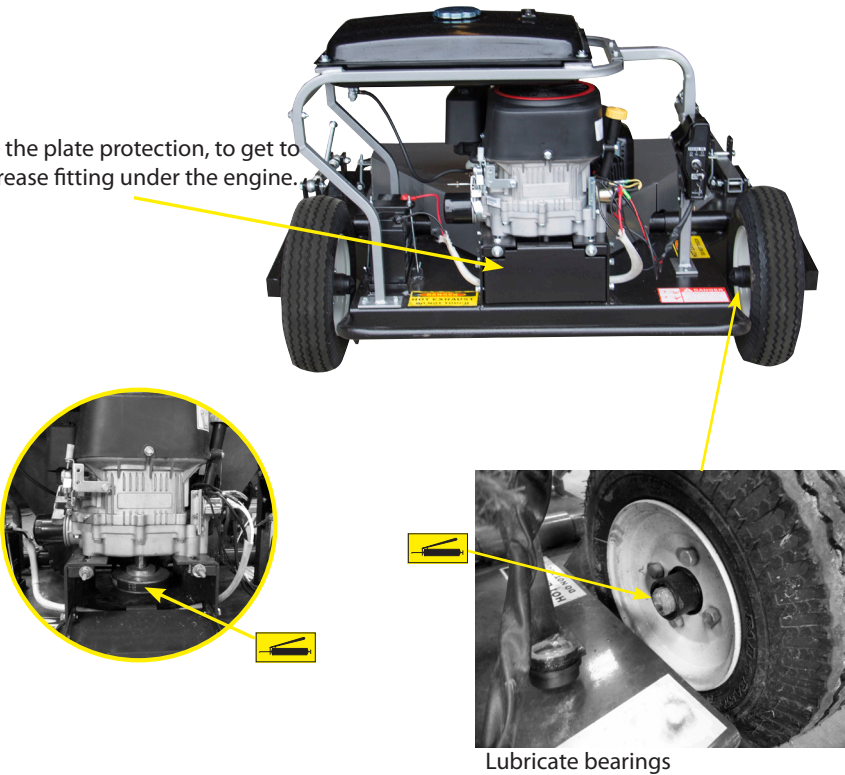

CHANGING OIL

Use the correct type of oil depending on temperature conditions.
Use SAE 5W-30 or SAE-30.
See table:

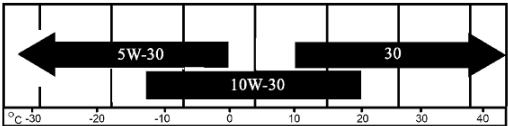

MAINTENANCE OF KNIVES

The mower is equipped with blades made to last for a long time. If a knife loosens or breaks down, it is important to replace it immediately. If not, there is a possible imbalance, which is very serious. If it is partly or completely worn out, it should be replaced to maintain the correct weight balance. Use of dull blades reduces the cutting efficiency and increases fuel consumption. Replacing of the blades is done as following:

- A) Make sure the engine is off and the blades do not rotate. Turn off the fuel valve and allow the engine to cool for five minutes. Remove the spark plug to be sure that the engine can not start.
- B) Raise the mower to its maximum cutting height.
- C) Gently raise the mower into a slightly inclined position. **IMPORTANT!** Ensure that the mower can not tip over.
- D) Loosen and remove the bolts.
- E) Replace blades.
- F) Insert the bolts properly, and check that the blades can move properly on the shoulder.

IMPORTANT! Never use worn, cracked or repaired knives. Replace with new ones.

IMPORTANT! For repairs beyond the previously listed adjustments, please contact your local dealer.

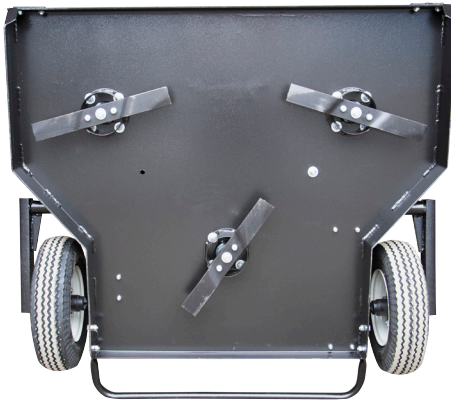

SERVICE	INTERVAL	MEASURE
Knives	Before every use.	Kontrollera knivar Check knives Replace any defective blades. Sharp blades provide better results. When replacing knives, bolts must be tightened properly.
	During operation.	Listen for noises
	After every use.	Control and check.
Straps	Before every use.	Strap tension. At pressure, the strap should be moved 20 mm.
Knife shafts and bearings	Before every use. Every 5th operating hour.	Lubricating
The mower	After every use.	Remove dirt and grass with water.
Oil	Every 500th operating hour or at least 1 time each year.	Changing oil.

LONG TIME STORAGE:

Before the storage, be sure to follow the below

- Drain the engine on or add a stabilizer in the fuel to prevent fuel becomes messy.
- If you have added stabilizer, run the engine for about 5 minutes ..
- Turn off the engine.
- Pull the lever back and forth to release the hydraulic pressure.
- Remove the spark plug.
- Pour ca. one tsp (teaspoon) of oil into the spark plug hole. Cover the hole with a cloth and turn the engine a few times to lubricate the cylinders.
- Replace the spark plug.
- Never store the machine where there is a risk of fire. Allow the engine to swallow before storage.

RECYCLING

Disposal of the product, disassemble and transport to the municipality’s recycling station.
Contact your local authority for further information

TROUBLE SHOOTING	MEASURE
Mower cuts unevenly or poorly	Check that the blades are undamaged and secured properly. Check and tighten any straps.
The cutting sound changes.	Check knives. Check the tension of drive belts. Check the blade shafts and bearings
Vibrations	Check knives
Oil overheats <ul style="list-style-type: none">• dirty oil.• The inlet filter is clogged.• Safety valve is incorrectly set.• Engine runs too fast.• Unskilled driving, causes excessive oil flow valves.• broken oil pipeline.• Wrong type of oil in hot hot weather.	<ul style="list-style-type: none">• Change the oil and oil filter.• Cleaning the filter element.• adjust the valve.• Lower the speed.• Learn correct and smooth driving.• Replace broken wires.• Use the recommended oil.

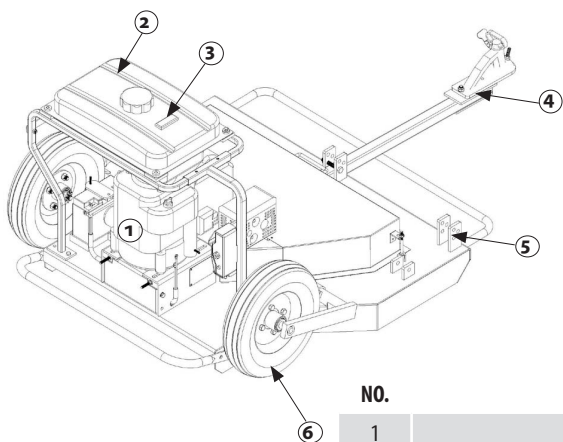

NO.	DESCRIPTION
1	ENGINE: 16 hp
2	Petrol tank, volume 13 L
3	Petrol level gauge
4	Ball coupling: 50 mm
5	Drawbar bracket: for use in sideways direction
6	Wheel: Maximum wheel pressure 2,06 Bar /30 PSi

SPARE PARTS

ART.NO.	NAME
R35-RKATV.001	Knife
R35-RKATV.004	Bearings for knives
R35-RKATV.005	Wheel
R35-RKATV.015	Strap disc 2-track
R35-RKATV.016	Strap disc 1-track
R35-RKATV.017	Strap disc - engine
R35-RKATV.018	Turn buckle
R35-RKATV.019	Draw boom

ASSEMBLY INSTRUCTIONS

STEP 1: Installation of the gas tank and the support frame

1. Assembly the support frame (3 parts #49, #51, #47), lock in place with 2 M8x35 (#53) and lock nut M8 (#4)
2. Mount the tank on the frame, lock in place with M8x25 (#2), spring disc Ø8 (#3) and large disc Ø8 (#52)
3. Mount the stabilizer bar (#50) for stabilizing the frame (A-A), lock in place with 2 M8x35 (#53) and lock nut M8 (#4)

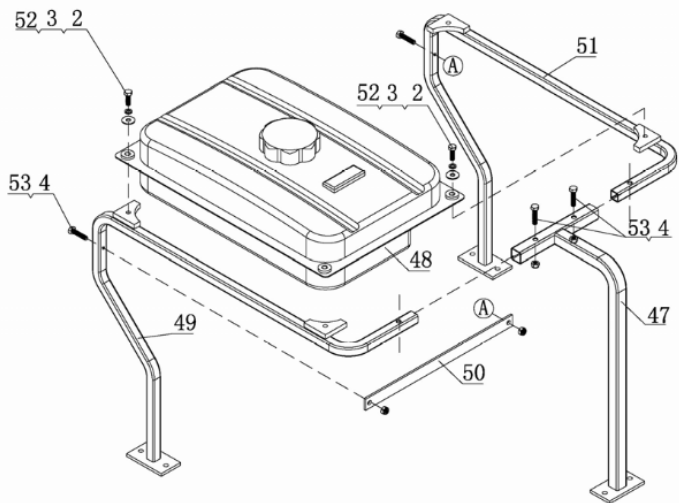

Step2: Install the draw bar

1. Install the draw bar in the desired position on the mower (see picture), lock in place with 2 bolts M12 x80 (#26) and M12 lock nut.

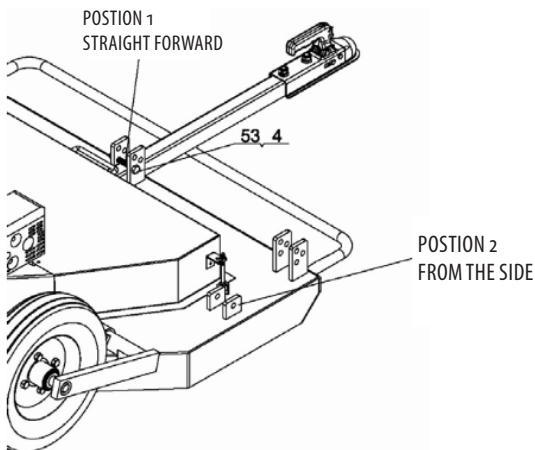

Step3: Installing the tank on the mower

1. Place the frame with the tank above the mower (#20) and lock in place with 6 bolts M8x25 (#2), spring disc Ø8 (#3) and lock nut M8 (#4)

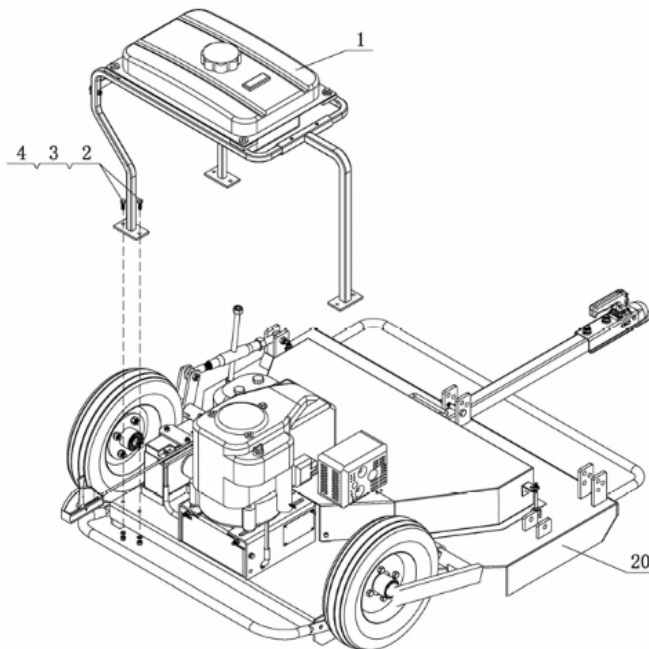

Step 4: Fill the engine with oil SAE 5W-30 /SAE 5-30

1. Make sure the mower is on an even surface.
2. Open the lid with the dipstick and fill with oil approximately 0,7L.
3. Check the engine oil level before each run.

CAUTION! Never start the engine without oil, always check before starting the engine, that it is filled with the correct amount of oil. Starting the engine without oil can result in engine fail.

Step5: Fill the tank with petrol

1. Use only clean, unleaded gasoline with minimum 85 octane rating.
2. Never mix oil and gasoline
3. Fill the tank. **NOTE:** Do not overfill the tank, always leave room for fuel expansion about 64cm from the tank opening.
4. Replace the lid and always clean spilled fuel.

CAUTION! Never start the engine indoors or in a poor ventilated place. Exhaust gas from the engine contains karbonmonoxid, colorless and odorless substance that is dangerous to inhale. Fuel vapors are extremely flammable, fill therefore not the tank with fuel when the engine is hot. Smoking is prohibited when the engine is replenished with fuel!

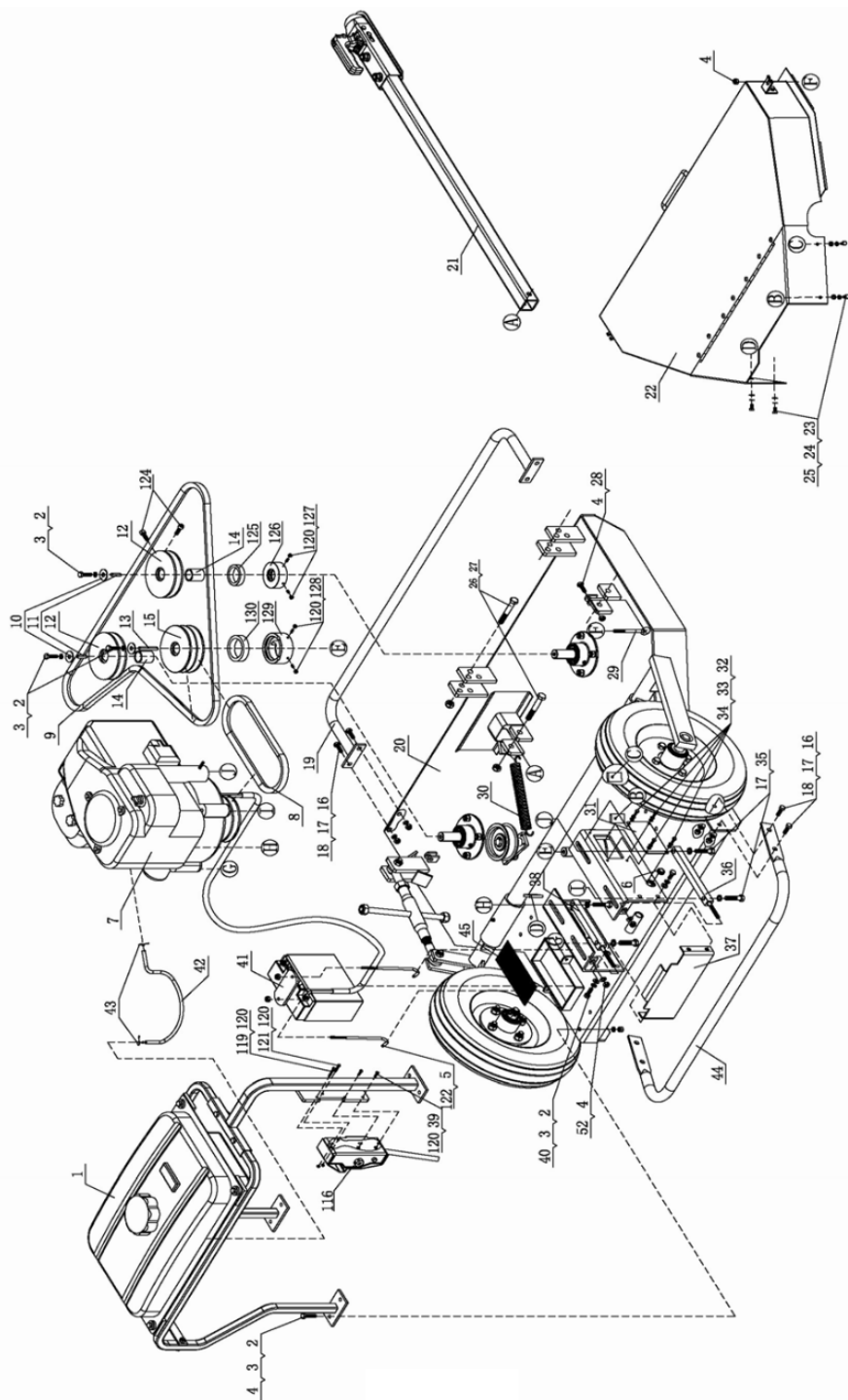

Pos no.	NAME	AMOUNT
1	Petrol tank	1
2	Six point bolt M8x25	13
3	Lock disc Ø8	13
4	Lock boltM8	12
5	Hooks for battery	2
6	Rubber bushing	2
7	Engine	1
8	V-belt SPB686	1
9	V-belt SPB2182	1
10	Disc for V-belt A	3
11	Wedge for pulley A	2
12	Pulley	2
13	Wedge for pulley B	1
14	Support roll	2
15	Pulley B	1
16	Six point bolt M10x25 (8.8)	8
17	Lock disc Ø10	12
18	Lock nut M10	8
19	Collision cover - front	1
20	Cutting head	1
21	Draw boom	1
22	Protection cover	1
23	Six point bolt M6x18 (8.8)	4
24	Lock discØ6	4
25	Washers Ø6	4
26	Six point bolt M12x80	2
27	Lock nut M12	2
28	Six point bolt M8x30	2
29	Hook	2

Pos no.	NAME	AMOUNT
30	Spring	1
31	Side disc	2
32	Six point bolt M5x12	8
33	Lock disc Ø5	8
34	Washers	8
35	Six point bolt	4
36	Adjustable disc B	1
37	Plate - back	1
38	Adjustable disc A	1
39	Six point bolt M5x20	2
40	Washers Ø8	2
41	Battery bracket	1
42	Hydraulic hose (350mm)	1
43	Hose clamp	2
44	Collison cover - back	1
45	Rubber disc for battery	1
52	Washers Ø8	2
116	Electric start	1
119	Six point bolt M5x35	1
120	Lock nut M5	10
121	Six point bolt M5x25	1
122	Lock nut M6	2
124	Screw M8x15	6
125	Sleeve	2
126	Clamp bushing	2
127	Screw M5x12	4
128	Screw M5x20	2
129	Clamp bushing	1
130	Bushing	1

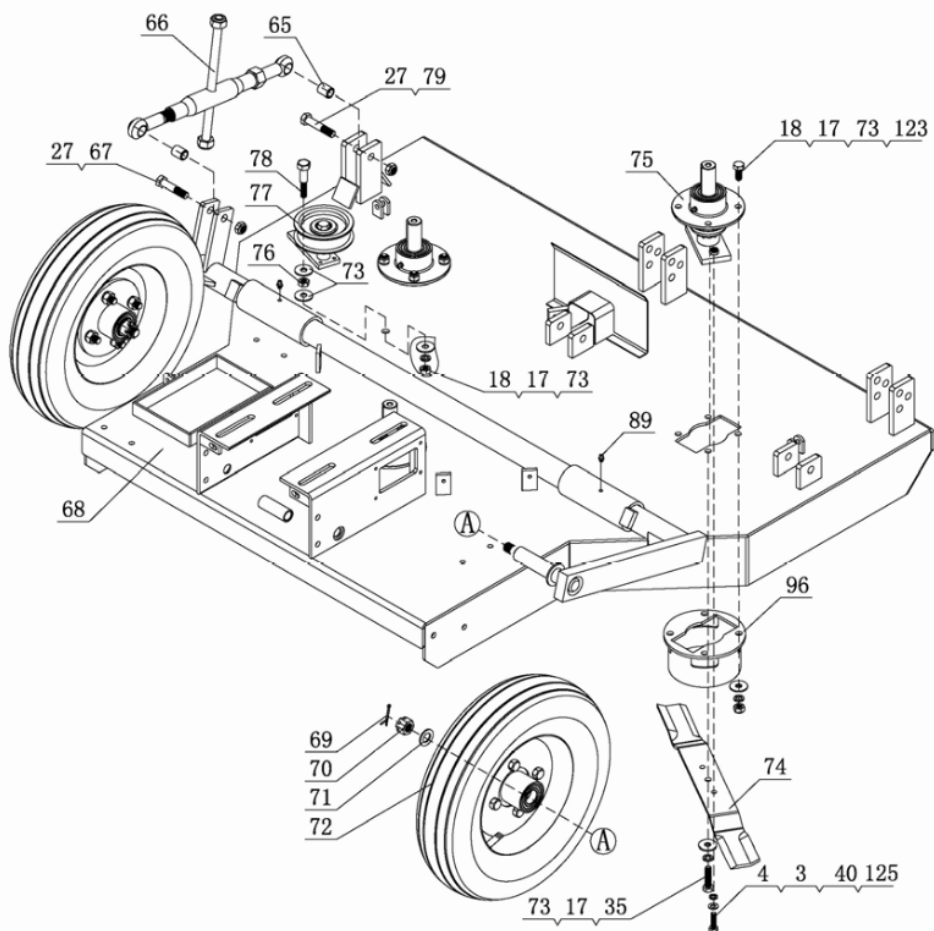

Pos no.	NAME	AMOUNT
3	Lock disc Ø8	6
4	Lock nut M8	6
17	Lock disc Ø10	16
18	Lock nut M10	13
27	Lock nut M12	2
28	Six point bolt M8x30	6
35	Six point bolt M10x45	3
40	Washers Ø8	6
65	Bushing	2
66	Adjustable handle	1
67	Six point bolt M12x55	1
68	Main frame	1
69	Cotter pin Ø4x40	2
70	Track nut M16x1.5	2
71	Washers Ø16	2
72	Wheel	2
73	Large washers Ø10	18
74	Knife	3
75	Knife holder	3
76	Nut M10	1
77	Tension roller	1
78	Bolt	1
79	Six point bolt M12x60	1
89	Grease fitting	2
96	Rotator cover	3
123	Six point bolt M10x30	12
125	Six point bolt M8x35	6

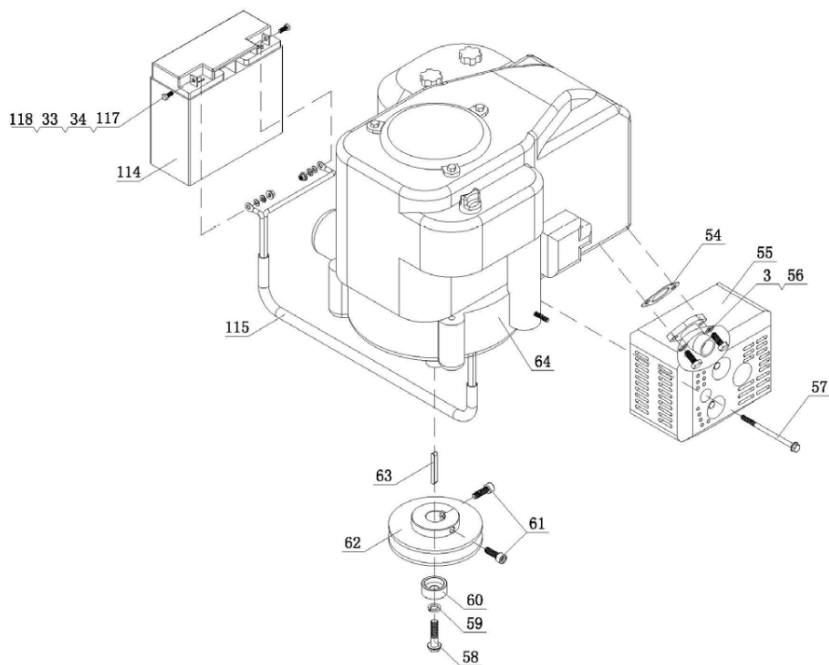

Pos no.	NAME	AMOUNT
3	Lock disc Ø8	2
33	Lock disc Ø5	2
34	Washers	2
54	Disc	1
55	Muffler	1
56	Six point bolt 5/16"x1"	2
57	Flanged pin M6x120	1
58	Flanged pin 7/16x40	1
59	Lock disc Ø12	1

Pos no.	NAME	AMOUNT
60	Bushing for engine	1
61	Socket head bolt M8x25	2
62	Pulley C	1
63	Wedge for pulley C	1
64	Engine 16hp	1
114	12V Battery	1
115	Wire	1
117	Six point bolt M5x16	2
118	Flangenut M5	2

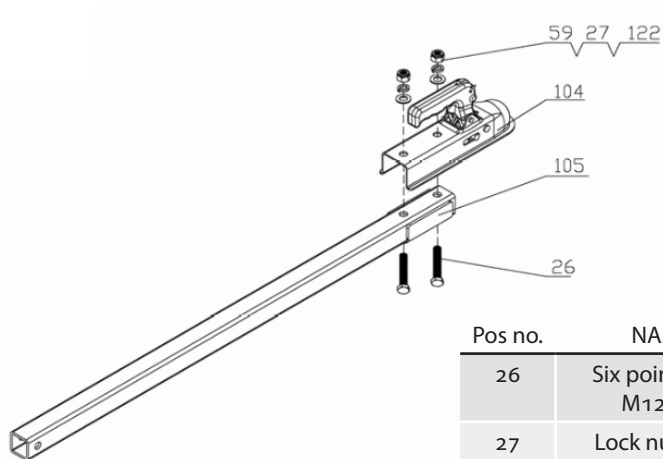

Pos no.	NAME	AMOUNT
26	Six point bolt-M12x60	2
27	Lock nut M12	2
59	Lock disc Ø12	2
104	Draw coupling	1
105	Draw pipe	1
122	Washers Ø12	

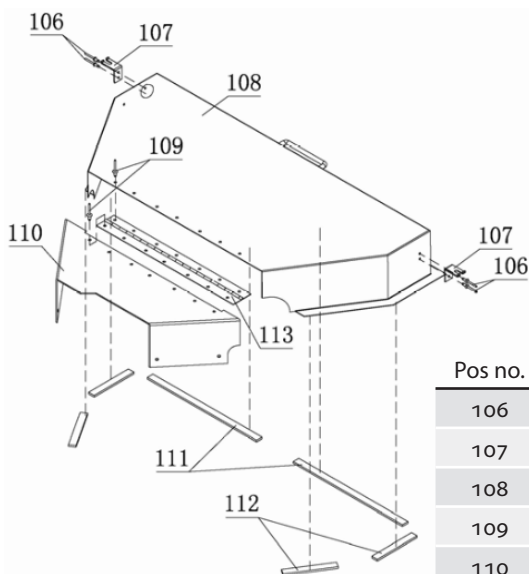

Pos no.	NAME	AMOUNT
106	Pop rivets Ø5x12	4
107	Clamp	2
108	Protective cover	1
109	Pop rivets Ø16x12	14
110	Strap cover	1
111	Rubber strip - long	2
112	Rubber strip - short	4
113	Hinge	1

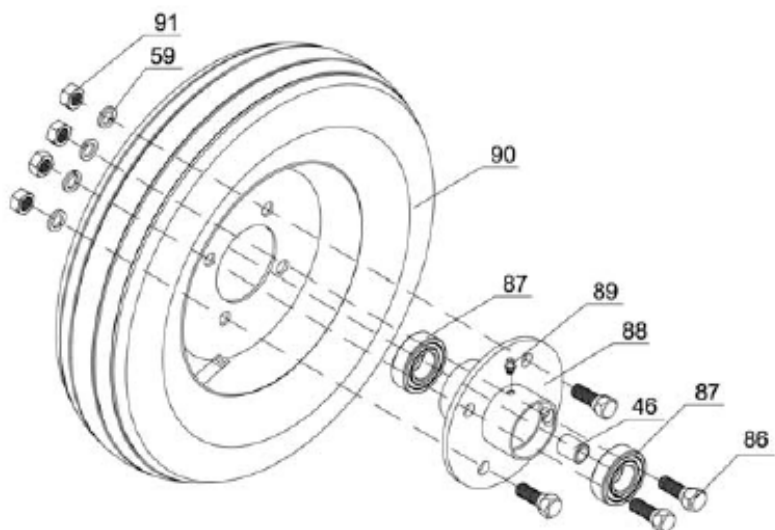

Pos no.	NAME	AMOUNT
46	Middle bushing	1
59	Lock disc Ø12	4
86	Wheel nut	4
87	Wheel bearings 0205	2
88	Flange ring	1
89	Greasing fitting M6	1
90	Wheel	1
91	Nut M12	4

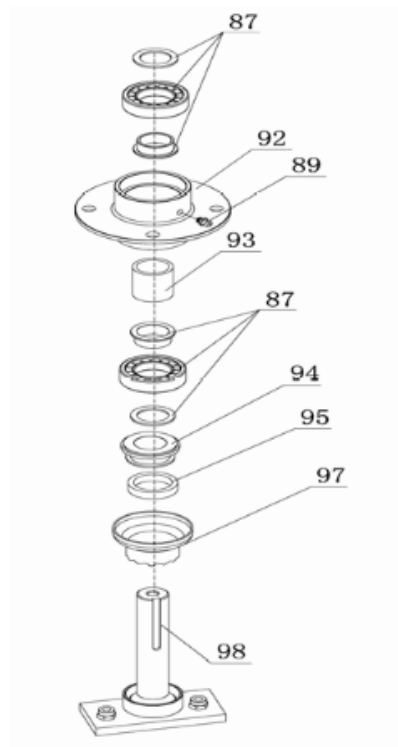

Pos no.	NAME	AMOUNT
87	Roller bearing	2
89	Greasing fitting M6	1
92	Flange	1
93	Bushing A	1
94	Bearing seat	1
95	Disc Ø30xØ39	1
97	Cover	1
98	Knife holder	1

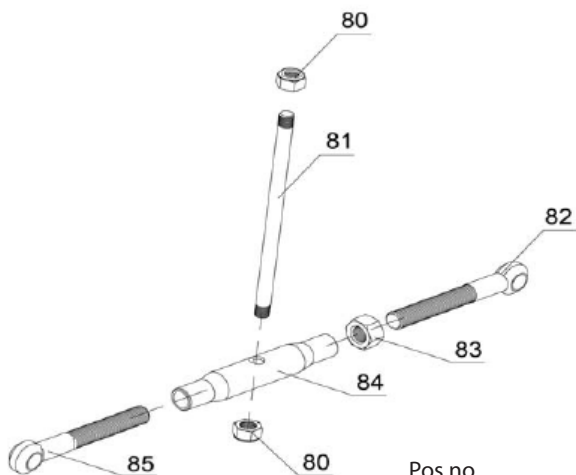

Pos no.	NAME	AMOUNT
80	Lock nut M14	2
81	Adjustable handle	1
82	Adjustable shaft A	1
83	Nut M20	1
84	Adjustable shaft - middle	1
85	Adjustable shaft - B	1

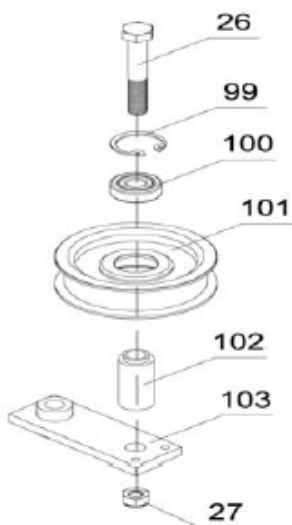

Pos no.	NAME	AMOUNT
26	Six point bolt M12x80	1
27	Lock nut M12	1
99	Lock ring A Ø32	1
100	Wheel bearing 6201	1
101	Pulley	1
102	Sleeve A	1
103	Bracket	1

We are grateful for your help pointing out any inaccuracies in the Kellfri product delivered to you. Before making a complaint read Kellfris general warranty and sales conditions in our catalog as well as the enclosed User's manual that comes with the machine.

Please fill in the details below and attach photo and other information in order to process your request.

Buyer:	Customer number:	
Adress:	Invoice number:	
E-mail:	Phone nr:	
When was the product delivered?	When was the product taken into operation?	Did the product functioned as it should upon the first operation?

Defect product / part:

.....

Problem description:

.....

.....

Describe the sequence of events:

.....

.....

.....

.....

.....

Others:

.....

.....

Submit Complaint form and photo to:

Kellfri AB

Division of Services : Contact Kellfri retailer

Or e-mail service.

info@kellfri.se

Signature:	Date:
-------------------	--------------

WARRANTY TERMS AND CONDITIONS

Validity of the warranty - Kellfri's Warranty is valid 12 months from the date of purchase.

This warranty replaces - Compensation for spare parts after acknowledgment that the fault lies on the material or manufacturing defects.

This guarantee do not cover

- Labour costs
- Travel expenses
- Any modification that the buyer himself has/had made.
- Any consequential damages that occurred out of damage to the machine.
- Damage due to normal deterioration of the machine, inadequate: service, user inexperience or use of spare parts which are not original.
- Wear parts such as hoses, seals, oils, and mechanical belts

EG-FÖRSÄKRAN OM MASKINENS ÖVERENSTÄMMELSE, ORIGINAL

EC-DECLARATION OF CONFORMITY

According to 2006/42/EC, Annex 2A

Kellfri AB

Munkatorpsgratan 6

532 37 Skara, Sweden

Declares that the machine

Name: 35-RKATV117

Type: ATV ROUGH MOWER

Complies with all applicable provisions of the Machinery Directive 2006/42/EC.

Other equipment must meet the hardware requirements of the Directive.

Tina Baudtler, VD

Kellfri AB is constantly working on further developing their products and therefore reserves the right to modify, among other things the design and appearance without notice.

CUSTOMER SERVICE

You are always welcome to give your feedbacks, reviews or ask us about our tools and products.

Kellfri AB

Phone: +46 (0)511 242 50

Fax: +46 (0)511 168 33

E-mail: info@kellfri.se

Edited: 2015-07-13