

# **Kellfri®**

## **33-JMATV SALT & FERTILISER SPREADER**



**READ THIS MANUAL CAREFULLY BEFORE USING THE PRODUCT !!!  
TRANSLATED FROM THE ORIGINAL**

## INTRODUCTION

Thank you for choosing a product from Kellfri AB. By following general safety information, operating instructions and common sense, you will have many years of enjoyable use of the product. Kellfris equipment and products are aimed to be use by active farmers with high demands on functionality.

## PRODUCT INFORMATION

Kellfri's salt and fertiliser spreader for ATV or small tractor, friction-driven via the wheels, with accurate adjustment for precise spreading amount. Lateral spreading can be restricted, good for spreading along edges or ditches, accurate adjustment of spreading amount, and with the option of adjusting the four spreader fins. Mixer in the hopper for even output of material, suitable for manure, seeds, salt etc

## NOTE ! THE MACHINE IS DELIVERED UNASSEMBLED !

## INTENDED USE

The equipment is intended for spreading manure, can also be used for spreading seeds, salt, sand etc.

TECHNICAL DATA	33-JMATV
Volume	160 liter
Weight	63 kg
Wheel diameter	360 mm
Tires	Air tires
Package size	920 x 900 x 380 mm
Ball coupling	50 mm

## BASIC SAFETY INSTRUCTIONS

Before using the product, please read the safety information and instruction manual and understand its contents for your own and others' safety. Always keep the safety information and instruction manual easily accessible to the user of the product. Remember that it may be good for your own and others' safety to read the safety information every now and then. If the instructions manual is damaged or otherwise unusable, please contact and order a new one from: Your retailer



**CAUTION!**

The machine's original design must not under any circumstances be changed without the permission of the manufacturer. Unauthorized modifications and / or accessories can result in life-threatening or fatal injury to the operator or others.

The general safety instruction is also available from Kellfri's website: [www.kellfri.co.uk](http://www.kellfri.co.uk)

Do not use this equipment if you are feeling sick, tired or in influence of alcohol. Nor if you are under the influence of strong medications or drugs, suffering from strong depression or severe mental illness. Always follow the general traffic rules and regulations and the rules of the Animal Welfare Act. Persons under 15 years old and people with mental illness may not use these product.

## PRODUCT SAFETY INFORMATION

- Read the instructions carefully before using the machine
- The product may only be used in the manner described in this instruction
- Never put your hands or feet under the machine without first stopping the machine
- Never leave the equipment with the ATV's engine running. Turn off the engine and apply the parking brake when you leave the machine unattended, even for a short while
- Always disengage the machine before performing service or maintenance work
- Only the operator may be in the vicinity of the machine during work
- Never allow anyone to ride on the machine or towing vehicle
- Never stand or walk underneath a raised implement, ensure that it is properly supported and locked.
- Make sure all guards are fitted and can not come loose.
- Always be two people to handle heavy and bulky parts during assembly, handling and movement.
- Risk of crushing! Never put your hands or feet on the machine's spreader roll
- Observe the maximum payload! Never overload the machine!
- Fill the spreader tank directly on the field. The container of the spreader could be damaged if the machine is transported with loaded container








## INCASE OF EMERGENCIES

In case of an emergency please dial 112.

Keep cell phone or emergency phone available specially when working alone. First aid kit and fire extinguishers must be kept easily accessible during all work, maintenance and service.

## WARNING LABELS

Make sure that the warning labels are always visible, clean the warning labels if necessary. Do not wash with high pressure washer directly on the warning label. If any part of the decal is worn or label becomes frayed or otherwise unreadable, order new decals.

	Read the instruction manual! Before starting the operation
	Warning! Before maintenance, service, connection and disconnection of the machine to the tractor's engine should be switched off and the ignition key removed.
	Warning ! ejection of objects! Warning! Prohibition to stay on the machine! Risk zone 200 m Respect the risk zone of the implement!
	Warning! Rotating knives! Risk of crushing!
	Warning! Risk of Child Accident! Children are not allowed to be anywhere near machine.
	Warning! Prohibited to be on the machine!
	The product is CE-marked

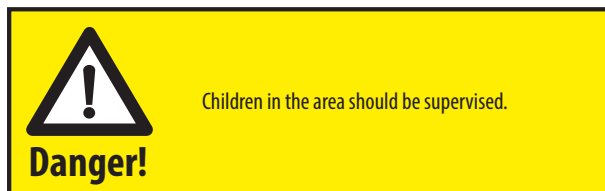
## PERSONAL PROTECTION

Always use appropriate protective equipment. Do not wear loose clothing or jewelry when working with the equipment. Remember to put up long hair when working with equipment that rotates. Wear gloves, a risk of burns upon contact with hot surfaces such as. the exhaust system, and to avoid oil and gas on the skin. Hearing protection should be used when the engine is running. Use appropriate protective equipment adapted to the chemical used.



## SURROUNDINGS

Make sure the area is clear of people, children and objects before switching on or using the machine. Risk of serious injury. Be especially careful if children are in the area where the equipment or product is being used or stored. Check that there are no low- hanging power lines in the working area. Be careful when working on slopes and near ditches. Always work alone with equipment designed for single - purpose tools/products. Never have junk in your working area. Keep work surfaces clean. Always respect the machine's danger zone. Stay away about 100 meters from humans, animals and buildings. Stop the spreader if someone comes closer, particles from the spreader can damage the eyes.



## BEFORE USE

Read the safety information and operating instructions carefully. Be sure that you understand the safety information, operating instructions and warning labels. Use common sense when using the machine and use appropriate personal protective equipment. Always check the performance and the machine combination that are used. It's highly important these matches in a satisfactory manner. This is to ensure the product or the function and most important yours and others safety. Visually inspect the equipment or product before using it. Fix or replace damaged or worn parts immediately to reduce the risk of injury. Lubricate moving parts and check that all nuts and bolts are tightened.

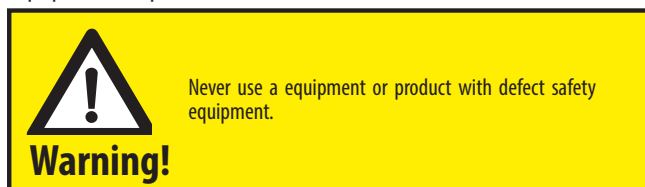
Learn and remember correct working method. Beginners should keep a low speed until the person has learned how the machine works. The user / customer is responsible to handle the situation correctly. Do not use the machine if it is experienced to be dangerous for the user.. Read the tractor's manual before connecting the machine.

## CONNECTING

- Connect the spreader to the ATV tow ball.
- Reduce speed when working on slopes and uneven terrain
- Ready to use

## USE

Only people who understand the safety information and instructions in this manual may operate the equipment. Be alert and careful when working with the machine and only use the equipment or product in the manner described in this manual.



When working with equipment that has moving parts, there is always the risk for injury. Always work alone with the equipments that are defined as single porpose equipments. Never overload the trailer. Respect the equipment's danger zone.

Make sure you know the distribution capacity of your machine and the material to be used. Test drive on the field to be sure that the spread will be right aligned. To generous spreading can damage the crop and ungenerous distribution may not produce the desired results.

- Reduce speed when working on slopes and uneven terrain.
- Make sure that no foreign objects is in the fertilizer to be spread.
- Follow the guidelines that the ATV manufacturer provides regarding towing / pulling of equipment / utensils.
- Do not fill the spreader container when you are transporting the equipment on longer distance. Because the contents can get packed and affects the ability to spread.
- Be extremely careful if you spread herbicides when there is a risk of uncontrolled proliferation of wind that can lead to damage when spreading onto the vegetation outside the area. Always follow the instructions for the chemicals you use.
- If there would be a stop in the feed: stop the machine, make sure all moving parts have stopped, and open the feeder cover completely. By puting a stick in the feeder you should be able to remove the object. **WARNING!** Risk of crushing!

### **SPREADING INSTRUCTIONS**

- The opening in the bottom of the spreader containers is adjusted with the control lever.
- The size of the opening depends calibration scale. Put the lever in the desired position.
- The spreading schedule in the manual is an estimate based on varying driving speeds .
- For proper distribution calibrate your towing vehicle to run at the desired speed.
- Close the feeder cover and pour in the material that will be disseminated. Run a test drive and make sure you gets the desired results. Make adjustments if necessary.

### **The spreading amount is determined with regards to:**

- The kind of fertilizer that will be spread
- Working width [m]
- Working speed [km / h]
- The desired spread rate [kg / ha].

Various factors such as wind, fertilizer humidity, etc. can affect the ability to spread.

### Adjustment of distribution mode:

Move the lever to the desired position and lock the pin.

The spreading quantity and position can be easily adjusted by opening 2 slots in the bottom of the container. The lever (B) under the spreader container adjusts the distribution position, the lever (A) at the side of the spreader container, adjust the distribution rate.

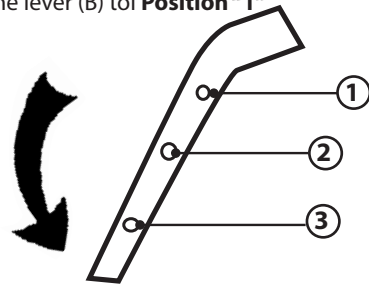
For general distribution in both directions move the lever (B) to **Position "1"**

For spreading to the left:

Move the lever (B) to **Position "3"**

For spreading to right:

Move the lever (B) to **Position "2"**



## Warning!

For safety, this product should only be used in the manner described in this manual. The user is responsible for the instruction to be read through and followed.

**NOTE!** because of the different density of fertilizers, adjustment of spreader blades may be necessary. By moving the blades to the left, you get more distribution to the right and vice versa.

The following distribution table is only general directions of the spread. The values may change due to external factors such as wind, moisture in fertilizers etc. The setting of the machine is affected by the operator's experience of the machine and the type of fertilizer.

Type of SEEDS	Spreading width (m)	The tractor speed (km / h) **	Kg / 4000m <sup>2</sup> (approximate value) Lever setting is indicated							
			0,5	1	2	3	4	5	6	7
Rice	9.4	6				51	82,5	149		
		8				41	66	120		
		10				34	55	100		
		12				28	44	80		
Rye	9.4	6				51	80	110	134	
		8				41	64	88	107,5	
		10				33,5	53	74	89	
		12				27	43	58,5	71	
Sudan grass	9.4	6			22	34	54			
		8			18	28	43,5			
		10			15	23	36			
		12			12	18	29			
Soybeans	11.6	6					48	75	88	100
		8					38,5	60	71	80
		10					32	50	59	67
		12					25	40	47	53
Timothy	4.6	6	8	28	69					
		8	6	23	56					
		10	5	19	47					
		12	4,5	15	37					
Wheat	9.4	6				41	65	89	116,5	
		8				33	53	71	94	
		10				27	43,5	59	78	
		12				22	35	47	62,5	

#### Problem

There is not coming any fertilizer/ seeds from the spreader, uneven distribution of fertilizers

#### PROABLE CAUSE

Packed fertilizer on the spreading discs and spreader blades

Control plates are not completely open / closed

#### MEASURE

Clean the spreader blades and spreading discs.

Warning! Risk of crushing rotating parts shall not be touched



Type of SEEDS	Spreading width (m)	The tractor speed (km / h) ** (km/h)	Kg / 4000m <sup>2</sup> (approximate value) Lever setting is indicated					
			0,5	1	2	3	4	5
Alfalfa & Clover	24' = 7,3	6	8	28	69			
		8	6	23	56			
		10	5	19	47			
		12	4,5	15	40			
Grain	26' = 7,9	6				43	53	64
		8				43	43	51
		10				28,5	35	42
		12				23	28	33,5
Bermuda grass	17' = 5.2	6			12	43		
		8			10	26,5		
		10			8	24		
		12			6	14		
Spanish Losta	9,5' = 2.9	6	4	7	11			
		8	4	5	9			
		10	3	4,5	7			
		12	2	4	6			
Fescue and Ryegrass Seeds	17' = 5.2	6		6	20	47		
		8		2	16	35		
		10		4,5	13	29		
		12		4	10	23		
Bush clover	30' = 9.1	6	3	6	13			
		8	2	5	10			
		10	1,8	4,5	9			
		12	1,3	4	7			
Oats	26' = 7,9	6				27	42	77
		8				21	33,5	62
		10				18	28	51
		12				14	22	41

## AFTER USE

Parking is not allowed with the equipment above ground, always park with the equipment resting on the ground. The spreader should be washed after use, especially if you use corrosive chemicals such as fertilizer, salt or equal. Wash thoroughly with strong detergent to remove all remains of chemicals after use. Once it has dried, lubricate properly.

## **TRANSPORT AND STORING**

Make sure there are no people, children and foreign objects around the area before transporting the machine. Always take an extra caution during the transport. Ensure that the product is well secured and that transport brackets are mounted. Always place the load as low as possible. Respect the danger zone even during transport. When lifting the equipment, never go underneath suspended loads. Trailer used for transport should have working brakes.

Always store the machine in a dry place preferably underneath a cover when not in use. Ensure that the product is stable and not likely to tip over. Never let children play where the machine is being stored. Always keep in mind the risk of tipping!

If the implement is heavily loaded, it may affect the stability of the towing vehicle. Be careful when moving. Slow down in turns and watch out for bumps and speed bumps. Maximum speed when towing is 30km / h. Keep the equipment in a place where people are not present and never let children play around the parked machine.

## **MAINTENANCE AND SERVICE**

Ensure that the unit is stable and cannot tip over during maintenance and service. Replace damaged or worn parts immediately to reduce the risk of abrasion. The tractor engine must be switched off and the equipment is lowered to ground level before working with the service begins. Make sure the equipment is stable and not likely to tip over during maintenance and service. Lubricate all moving parts and grease nipples and check hoses regularly. Check hydraulic system and the condition of oil. Use only original replacement parts or spare parts with equivalent performance to reduce the risk of damage. All repairs and connections with electricity must be performed by a qualified person. Check all nuts and bolts are tightened after performing maintenance and service. Always follow the maintenance safety regulations according to schedule. It's important to check the disc, given the danger that can occur if they come loose during operation.

- Regularly check the condition of the equipment before failure is a fact. Discovered cracks, twisting, bending, gaps or fatigue stop the operation and rectify the errors. Worn parts should be replaced.
- Re-tighten all nuts and bolts after a few hours of driving and after a day of operation.
- Disconnect the equipment from the towing vehicle when the fixing any faults.
- Check that all bolts and nuts are tightened after maintenance and service. Always test the machine before work is started.
- Lubricate moving parts regularly.
- Touch up with paint where metal or rust is visible
- The gearbox is filled with oil and sealed at the factory. With proper use and storage gear will last a long time and trouble free. If it should become necessary to disassemble the gearbox, it is essential to fill with oil of good quality and that the transmission parts are re-sealed with silicone glue.

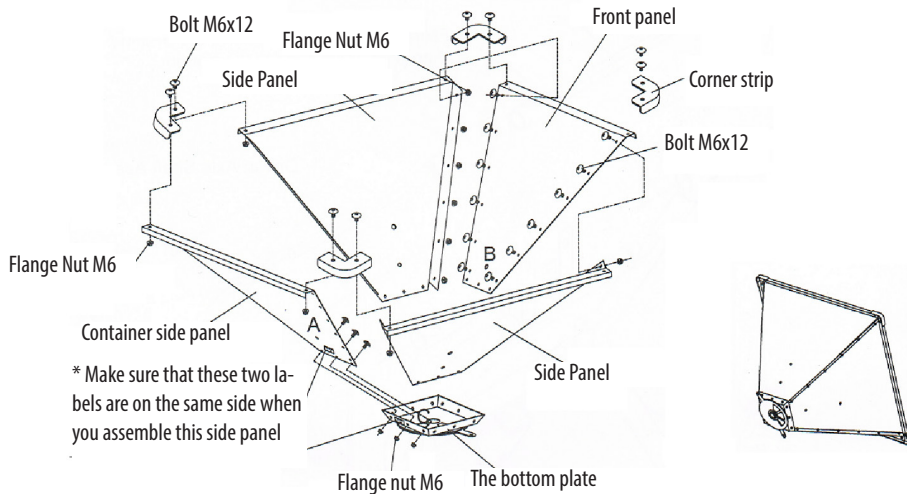
## **RECYCLING**

Disposal of the product, disassemble and transport to the municipality's recycling station. Contact your local authority for further information.

## ASSEMBLY INSTRUCTIONS

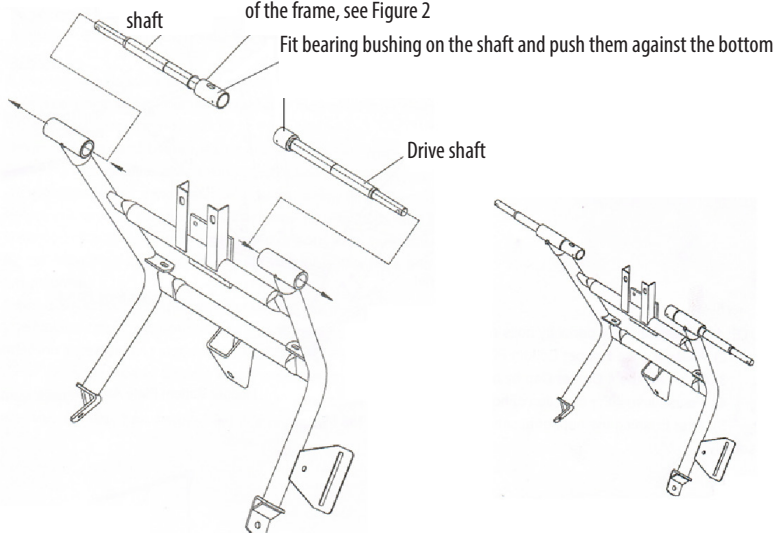
1. Assemble the four side panels, secure with nuts and bolts see picture (Figure 1)
2. Then mount the spreader baseplate.
3. Fit the four corner protectors (Corner strip), tighten all nuts and bolts
4. Turn the container sideways during assembly to easily assemble it
5. When the mounting of the container is completed. Place the container side with decals down for the next assembly.

**FIGURE1**

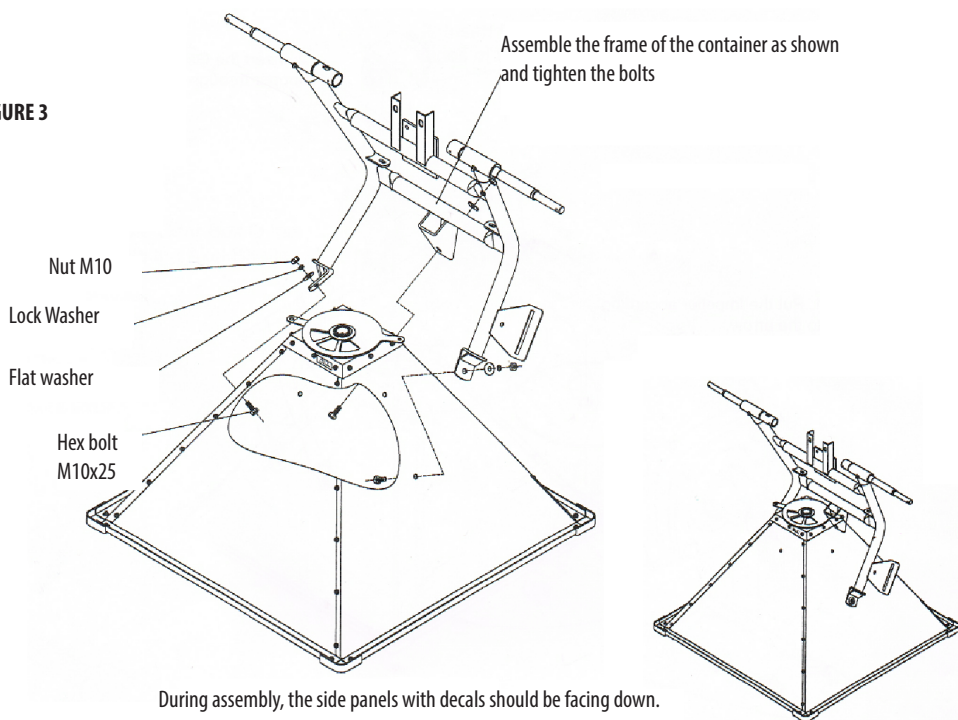


NOTE! Shaft with tracks should be mounted on the left side of the frame, see Figure 2

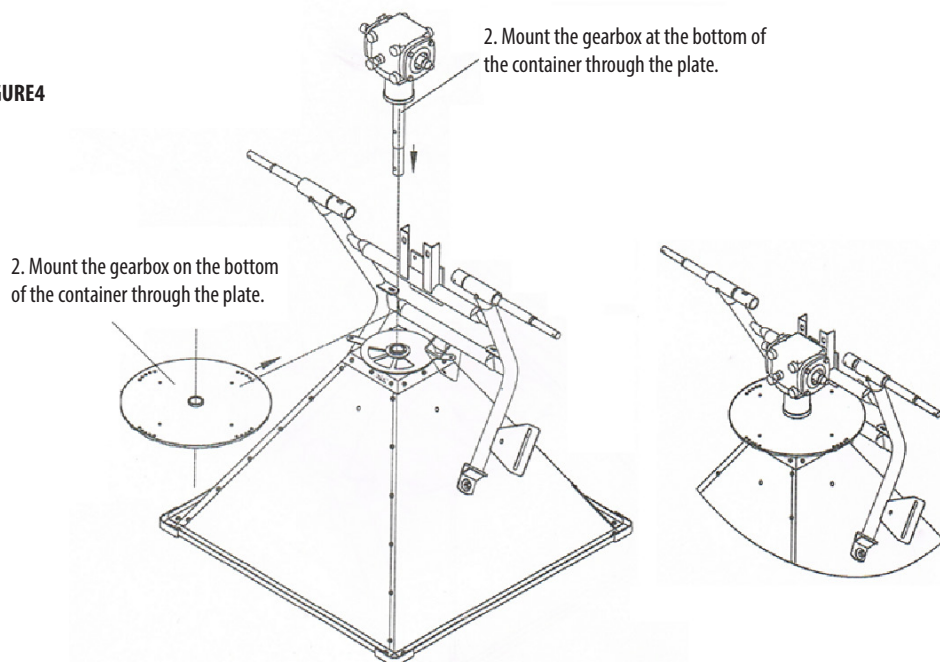
**FIGURE2**



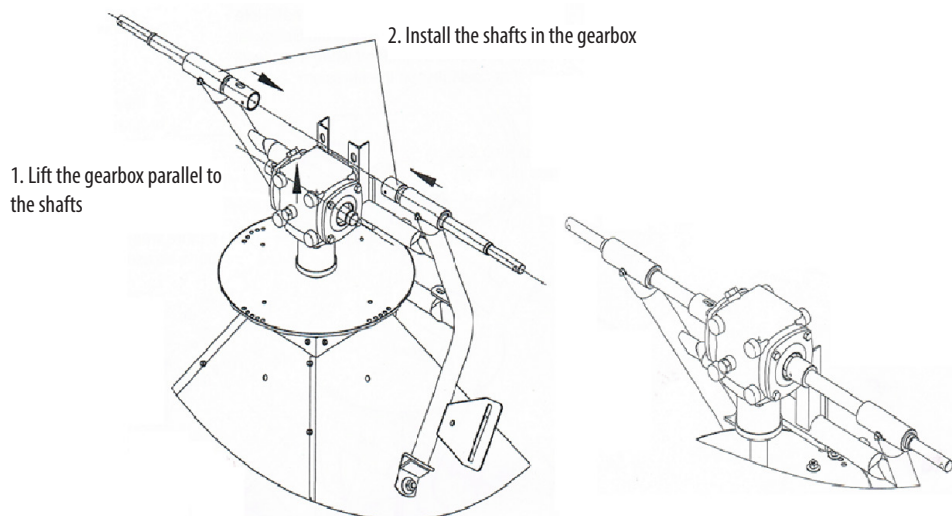
**FIGURE 3**



**FIGURE4**



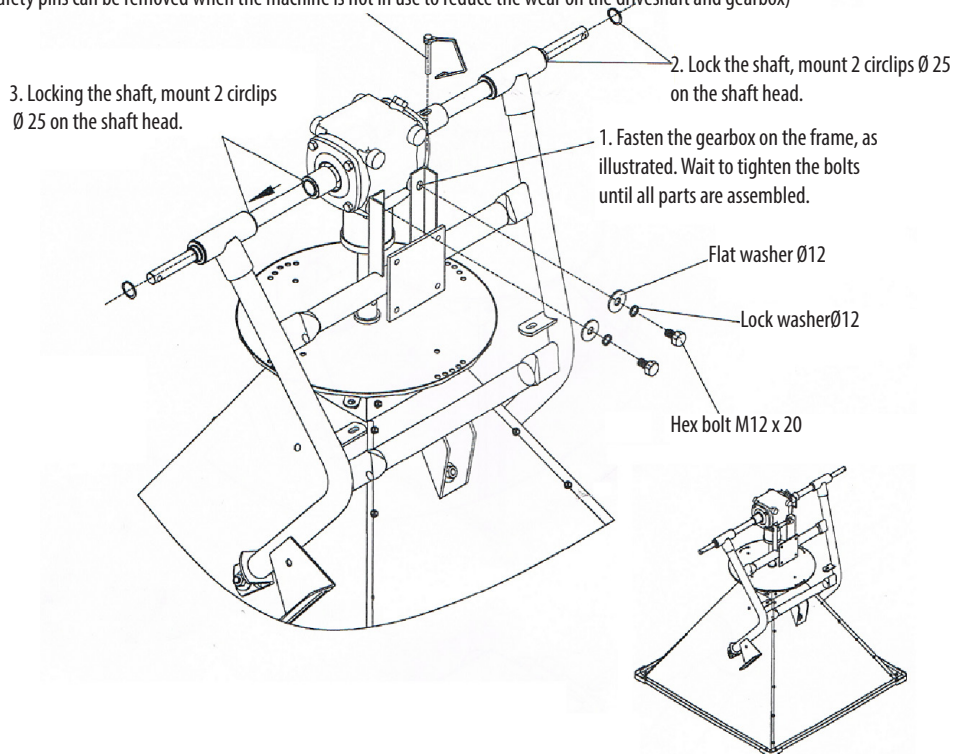
**FIGURE 5**



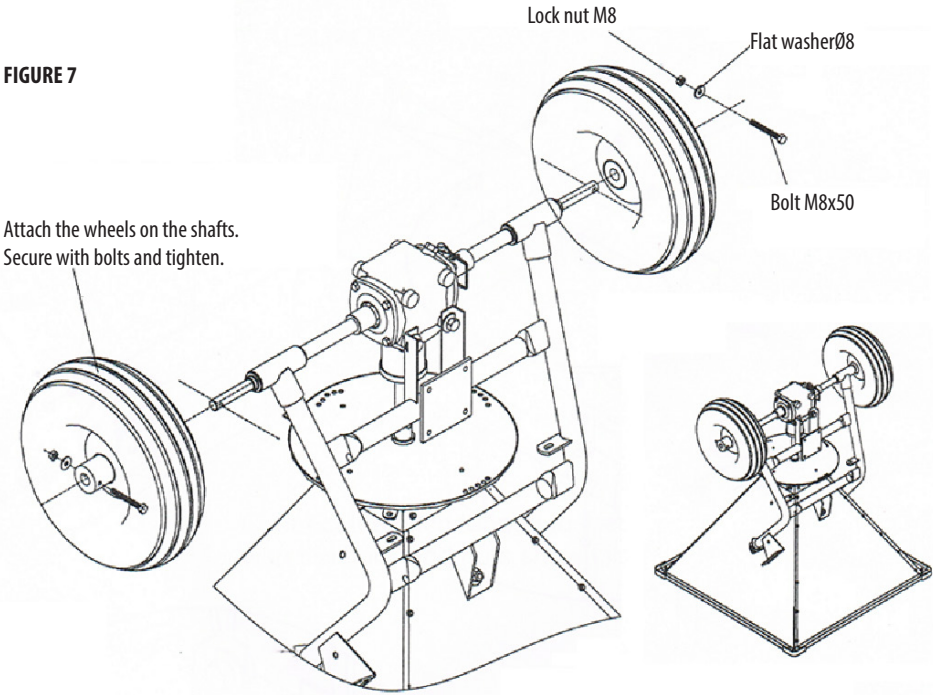
**FIGURE 6**

Lock the drive shaft in the gearbox by fitting the safety pin.

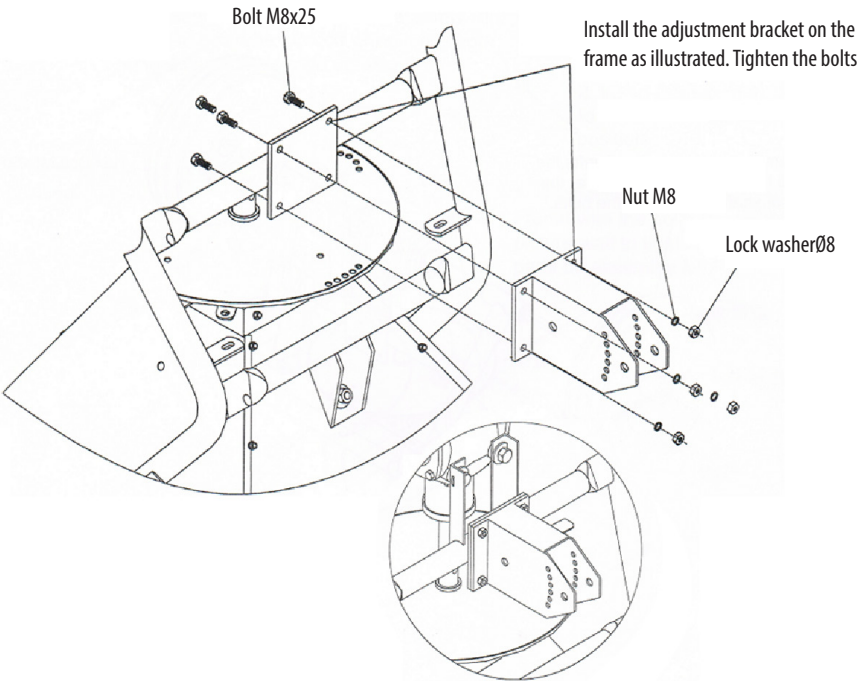
(Safety pins can be removed when the machine is not in use to reduce the wear on the driveshaft and gearbox)



**FIGURE 7**

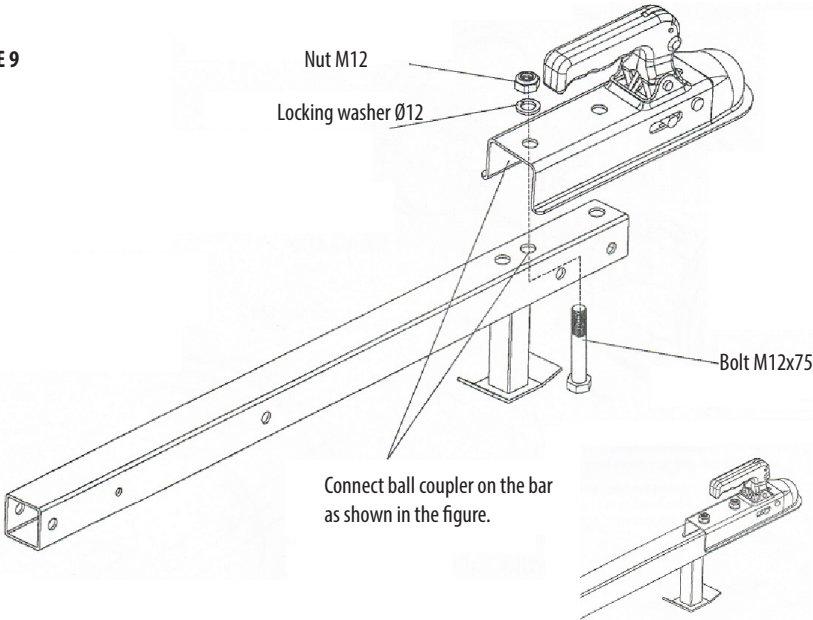


**FIGURE8**

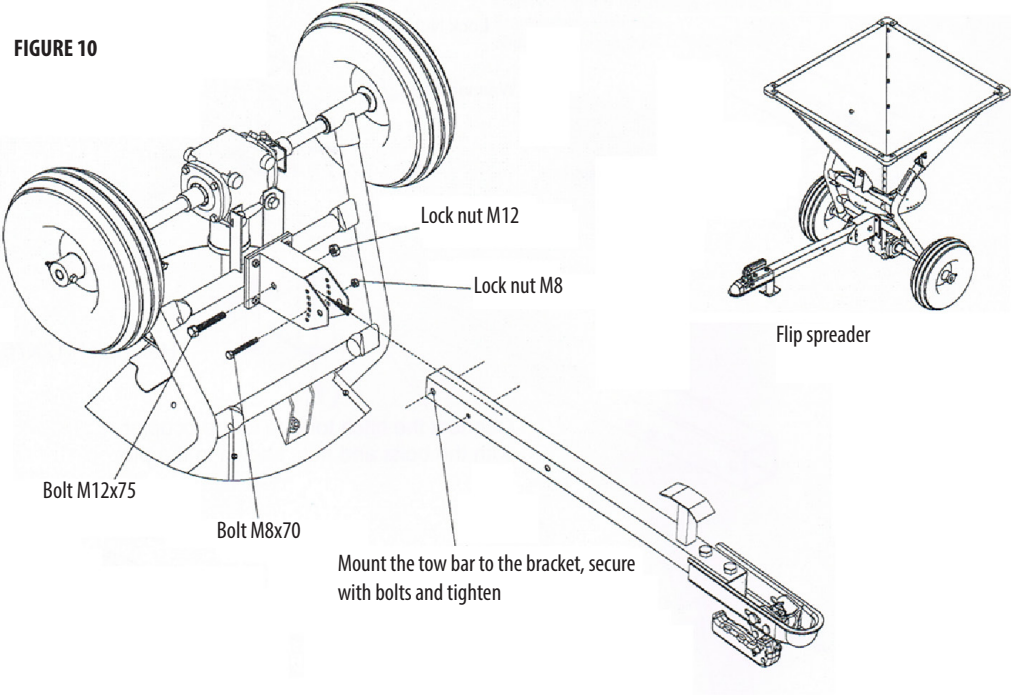




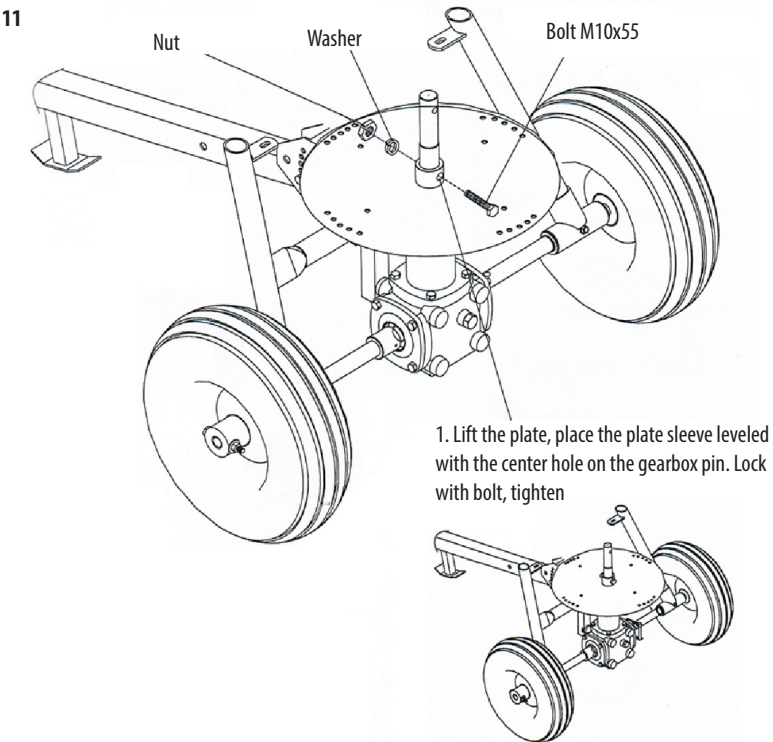
**FIGURE 9**



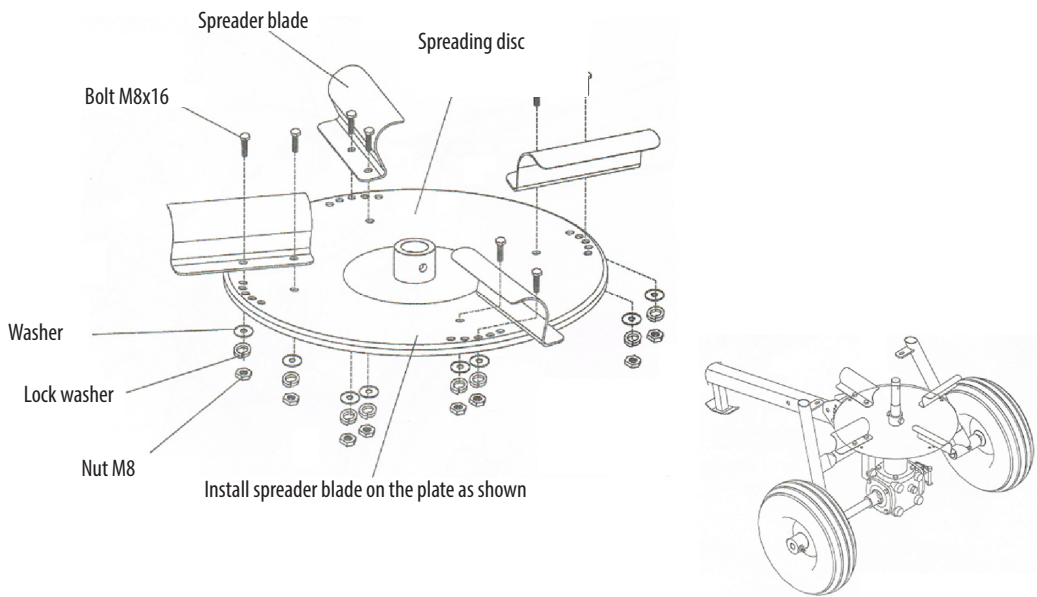
**FIGURE 10**



**FIGURE 11**

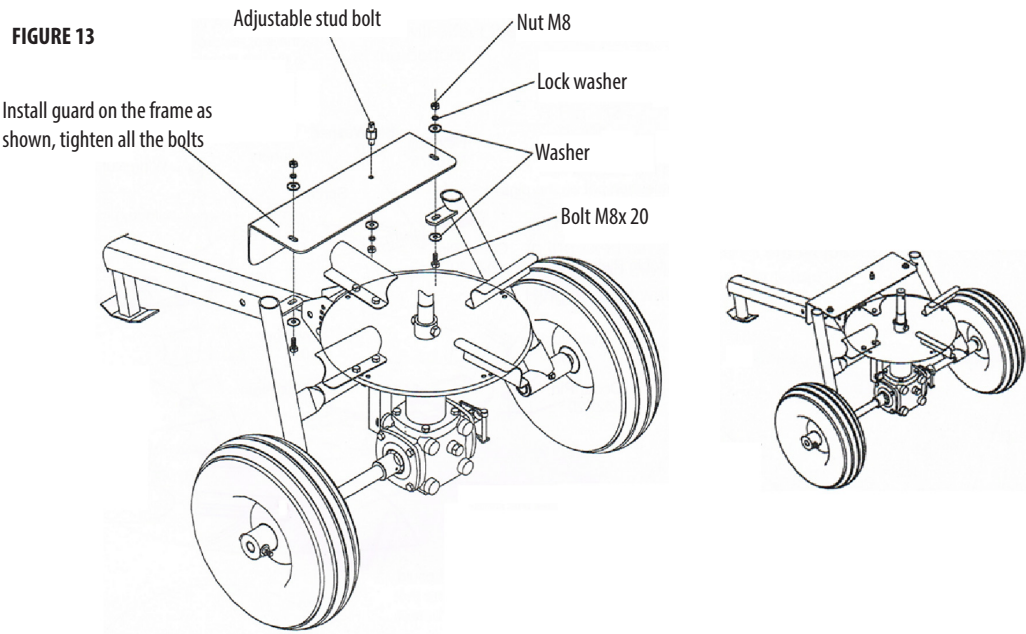


**FIGURE 12**

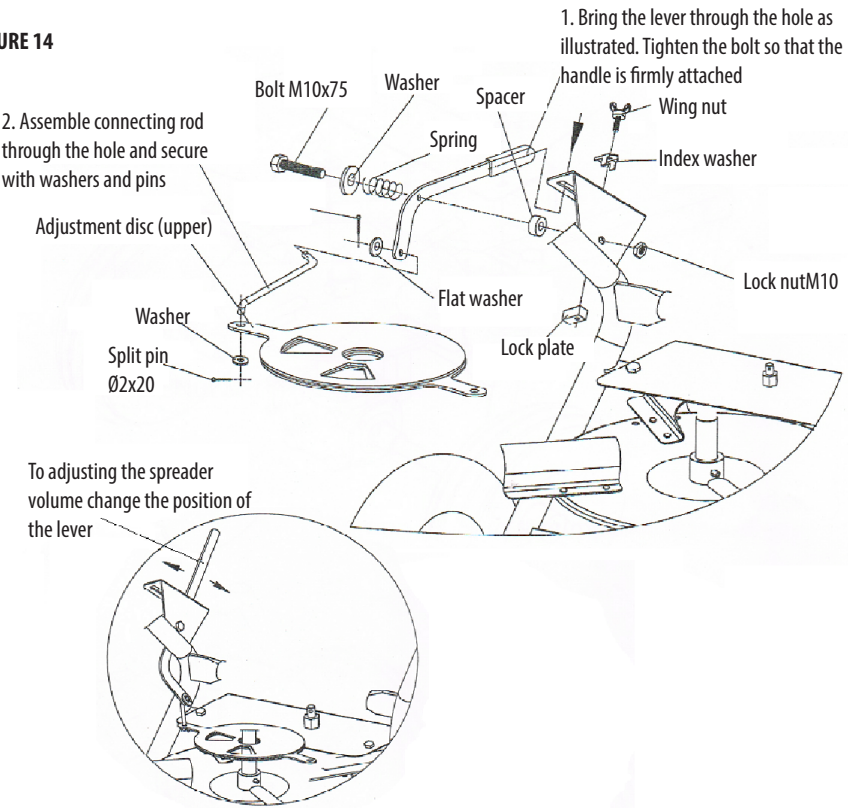




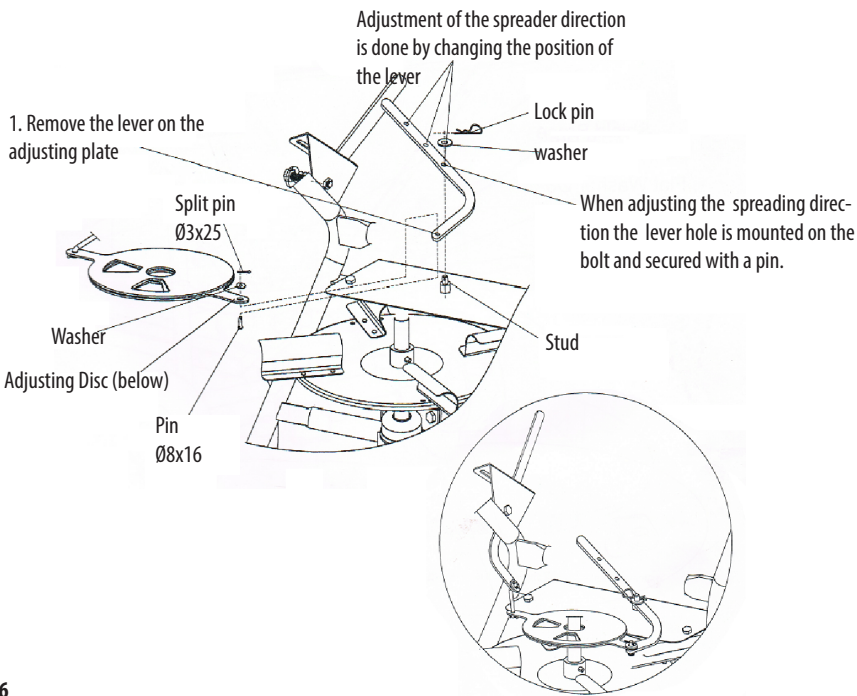
**FIGURE 13**



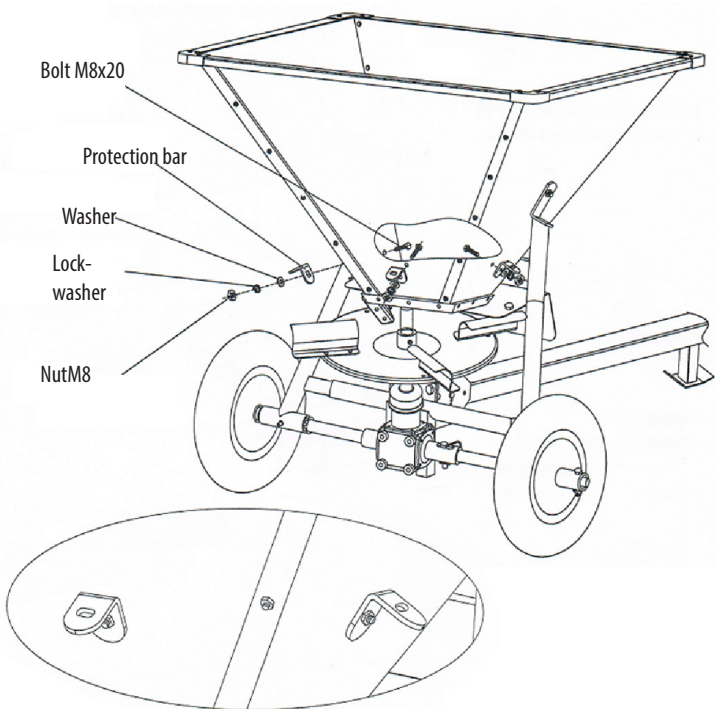
**FIGURE 14**



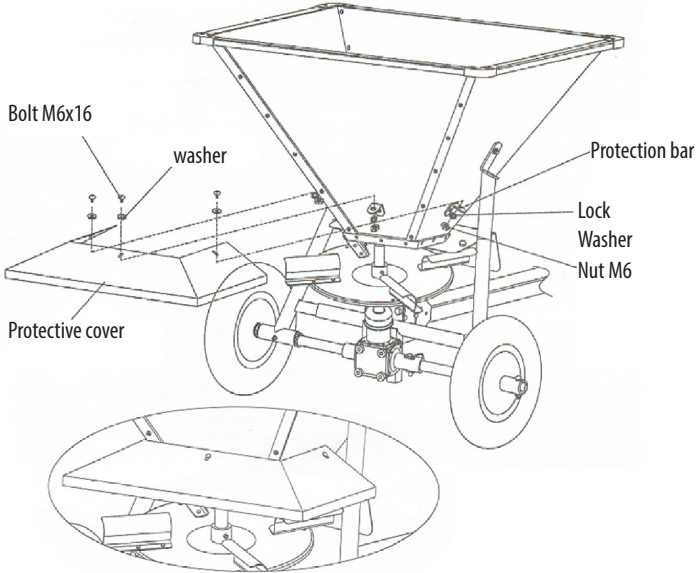
**FIGURE15**



**FIGURE 16**

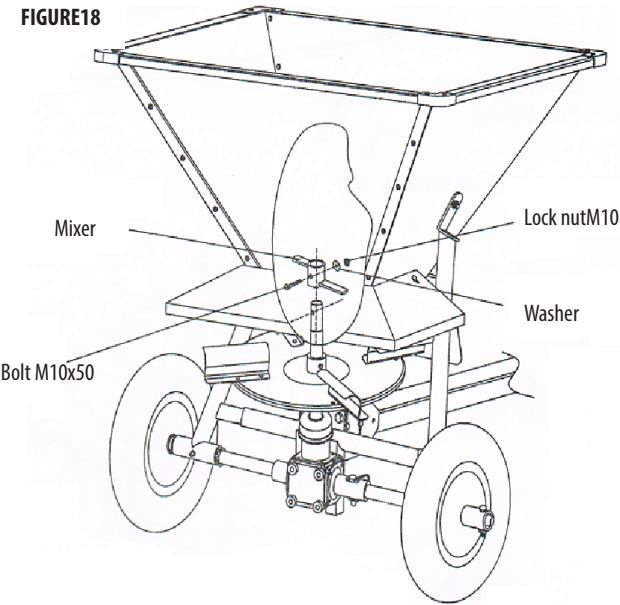


**FIGURE17**

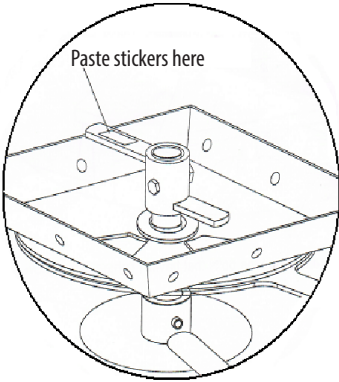


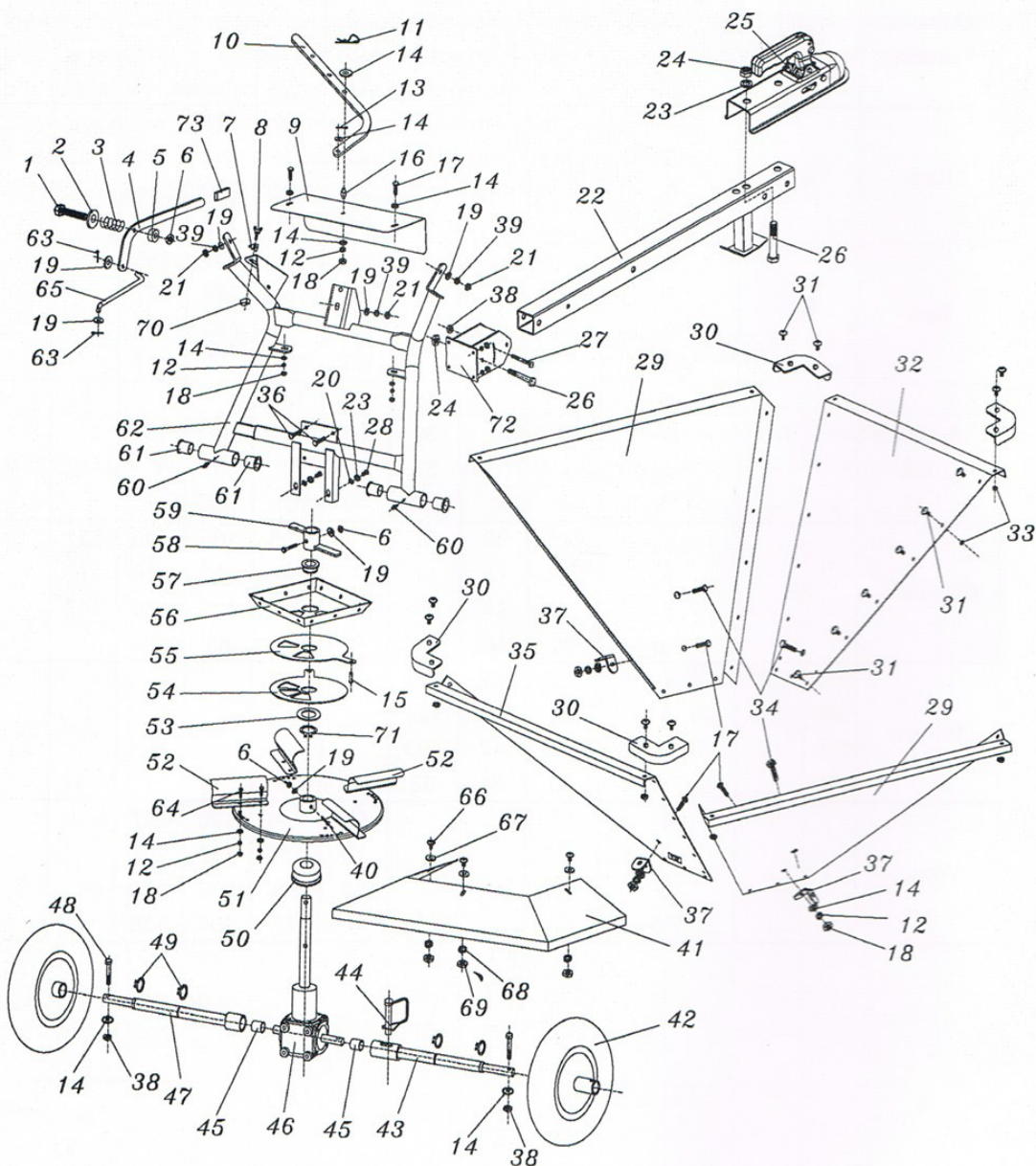
Tighten all bolts and nuts, even those who have not been applied in the previous step.

**FIGURE18**



NOTE! Decals should face upwards





NO.	DESCRIPTION	QTY.
1	Hex bolt M10x75	1
2	Washer Ø10	1
3	Spring	1
4	Adjustable lever	1
5	Washer	1
6	Hex Nut M10	3
7	Index	1
8	Wing nut	1
9	Protective cover	1
10	Adjusting handle (sub)	1
11	Locking pin ø 1	1
12	Lock Washer Ø8	18
13	Split pin Ø3x25	1
14	Washer Ø8	18
15	PIN	1
16	Stud	1
17	Bolt M8x20	5
18	Nut M8	18
19	Washer Ø10	7
20	Washer Ø12	2
21	Nut M10	3
22	Tow bar	1
23	Washer Ø12	4
24	Locknut	3
25	Ball coupling	1
26	Bolt M12x75	3
27	Bolt M8x70	1
28	Bolt M12x20	2
29	The container's side panel	2
30	Corner protection	4
31	Bolt M6x12	44
32	The container's front panel	1
33	Flange Nut M6	44
34	Bolt M10x25	3
35	The container's rear panel	1
36	Bolt M8x25	4
37	Protection bar	3

NO.	DESCRIPTION	QTY.
38	Lock nut M8	3
39	Locking nut Ø10	3
40	Bolt M10x55	1
41	Protective cover	1
42	Wheel	2
43	Shaft (left)	1
44	Safety Pin	1
45	Bearing bushing	2
46	Gearbox	1
47	Drive shaft	1
48	Bolt M8x50	2
49	Retain ring Ø25	4
50	Dust Cover	1
51	Spreading disc	1
52	Spreader blade	4
53	Washer Ø40	1
54	Adjusting plate (sub)	1
55	Adjusting plate (top)	1
56	The bottom plate	1
57	Shaft bushing	1
58	Bolt M10x50	1
59	Mixer	1
60	Grease nipple	2
61	Bearings	4
62	Frame	1
63	Split pin Ø2x20	2
64	Bolt M8x16	8
65	Coupling bar	1
66	Bolt M6x16	3
67	Washer Ø6	3
68	Lock Washer Ø6	3
69	Nut M6	3
70	Locking plate	1
71	Retain ring Ø40	1
72	Adjusting plate	1
73	Handle	1





**Spreading plate with 4 spreader blades.**



**Adjustment Lever A**



**Mixer**

We are grateful for your help pointing out any inaccuracies in the Kellfri product delivered to you. Before making a complaint read Kellfris general warranty and sales conditions in our catalog as well as the enclosed User's manual that comes with the machine.

Please fill in the details below and attach photo and other information in order to process your request.

<b>Buyer:</b>	<b>Customer number:</b>
<b>Adress:</b>	<b>Invoice number:</b>
<b>E-mail:</b>	<b>Phone nr:</b>

<b>When was the product delivered?</b>	<b>When was the product taken into operation?</b>	<b>Did the product functioned as it should upon the first operation?</b>
--	---	--

**Defect product / part:**

.....

**Problem description:**

.....

**Describe the sequence of events:**

.....

.....

.....

.....

.....

.....

**Other:**

.....

.....

*Submit Complaint form and photo to:*

*Kellfri AB*

*Division of Services : Contact Kellfri retailer*

*Or e-mail service.*

*info@kellfri.se*

<b>Signature:</b>	<b>Date:</b>
-------------------	--------------

## WARRANTY TERMS AND CONDITIONS

Validity of the warranty - Kelfri's Warranty is valid 12 months from the date of purchase.

This warranty replaces - Compensation for spare parts after acknowledgment that the fault lies on the material or manufacturing defects.

This guarantee do not cover

- Labour costs
- Travel expenses
- Any modification that the buyer himself has/had made.
- Any consequential damages that occurred due to damage to the machine.
- Damage due to normal deterioration of the machine, inadequate: service, user inexperience or use of spare parts which are not original.
- Wear parts such as hoses, seals, oils, and mechanical belts



## EG-FÖRSÄKRAN OM MASKINENS ÖVERENSTÄMMELSE, ORIGINAL

EC-DECLARATION OF CONFORMITY

According to 2006/42/EC, Annex 2A

Kelfri AB

Munkatorpsgratan 6

532 37 Skara, Sweden

Declares that the machine

Name: 33-JVMATV

Type: Salt & fertilizer spreader 160 kg ATV

Complies with all applicable provisions of the Machinery Directive 2006/42/EC.

Other equipment must meet the hardware requirements of the Directive.

Tina Baudtler, CEO 2015-09-08

*Kelfri AB is constantly working on further developing their products and therefore reserves the right to modify, among other things the design and appearance without further notice.*

### CUSTOMER SERVICE

You are always welcome to give your feedbacks, reviews or ask us about our equipments and products.

Kelfri AB

Phone: 0046 (0)511 - 242 50

Fax: 0046 (0)511 - 168 33

E-mail: [info@kelfri.se](mailto:info@kelfri.se)

**Kelfri®**