



Kellfri[®]

23-TV15ATV TIPPING TRAILER



**READ THIS MANUAL CAREFULLY BEFORE USING THE PRODUCT !!!
TRANSLATED FROM THE ORIGINAL**

INTRODUCTION

Thank you for choosing a product from Kellfri AB. By following general safety information, operating instructions and common sense, you will have many years of enjoyable use of the product. Kellfris equipment and products are aimed to be use by active farmers with high demands on functionality.

PRODUCT INFORMATION

Strong galvanised construction, generous dimensions and bogie with sturdy cross-country wheels make this trailer the unbeatable workhorse in our range. Fixed front stem with raised grid to protect against load movement, extruded flaps for strength, easily detachable fold-down side flaps, hanging tailgate with the option of restricting flap opening with a chain for spreading gravel etc.

The tailgate can easily be detached, as can the rear corner posts, giving a clear floor if required. Strong all-round trailer locks hold the flaps in place, metal-covered floor makes the trailer robust and suitable for tough driving, tipping with the aid of the ATV's rear winch. Rotatable 50 mm ball coupling for your safety, 1500 kg loading capacity for tough jobs and a value-for-money price - a workhorse from Kellfri.

ART. NO	23-TV15ATV
Total length	3040 mm
Floor length	2010 mm
Height	1330 mm
Headboard height	300 mm
Wight	310 kg
Load capacity	1500 kg
Tyres	22 x 11-10
Tipping angle	55°
Ball coupling	50 mm
Ground clearance	290 mm
23-TV15ATVFH	27 kg (optional)

INTENDED USE

Suitable for transporting loose materials such as hay, leaves, small goods, soil, etc. Take into account the maximum bearing capacity of the trailer, safety regulations and recommendations.

BASIC SAFETY INSTRUCTIONS

Before using the equipment or product, and for the safety of yourself and others, you must read the safety instructions and the instruction manual and understand its contents. Always keep the safety instructions and instruction manual handy for users of the equipment or product. For the safety of both yourself and others, it may be a good idea to read through the safety instructions every now and then. If the safety instructions or instruction manual gets damaged or in any other way cannot be used, new copies may be ordered from:

Kellfri AB, Munkatorpsgratan 6, 532 37 SKARA

Sweden. Tel.: +46 (0)511 242 50 (Pls. contact the retailer) <https://www.kellfri.co.uk/>

Do not use the equipment or product if you feel ill, tired or are under the influence of alcohol. Do not use the equipment or product if you are taking prescribed medication or drugs. Always comply with general rules of the road and applicable rules stipulated by the Swedish Protection of Animals Act. People under the age of 15 are not allowed to use the equipment.

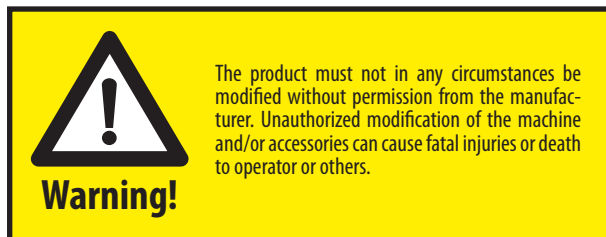

PRODUCT SAFETY INFORMATION

- It is the user's responsibility to read through the instructions and comply with them.
- Always check that the performance of the machine combination to be used with the trailer safety and functionality.
- Never overload the trailer!
- Never leave the driver's seat until the brakes on the towing vehicle have been applied.
- The risk area is 5 metres. Only the operator is allowed to be within the risk area while the trailer is in use.
- The operator may under no circumstances stay under suspended loads.
- Do not leave a loaded trailer parked unsupervised.
- When unhitching the trailer, it must be empty and on a level surface with the trailer wheels secured using suitable brake blocks.
- To stop trailer movements in the event of an emergency, stop the tractor.
- Be aware of the crush risk when carrying out winching work!
- When the carriage is not equipped with lights: complete with magnetic tail lights or equivalent if necessary.
- When driving on the road, the SMV sign be attached.
- The trailer is fitted with a 50 mm ball coupling. Regularly check the coupling. The maximum traction load for the ball coupling is 1000kg.
- EU regulations demands how fast a tractor with a non-brake trailer is allowed to drive. Comply with these regulations.

WARNING LABELS

Make sure that the warning labels are always visible, clean the warning labels if necessary. Do not wash with high pressure washer directly on the warning label. If any part of the decal is worn or label becomes frayed or otherwise unreadable, order new decals. When traveling on public roads, LGF plate must be fixed,visibly and clearly.

SYMBOL	EXPLANATION
	<p>Read the operating manual! Stop the engine for repairs</p>
	<p>Risk zone 5 m</p>
	<p>Warning for power lines! Warning! Risk of pinching hands! Warning! Risk of crushing feet!</p>
	<p>Do not permit anyone to stand under suspended loads. Warning—moving parts.</p>
 <p>Smörjning efter 10 tim. i drift</p> <p>Efterdrag samtliga skruvar och kopplingar</p>	<p>Greasing after 10 hours of operation Retighten all bolts and connections</p>
	<p>Warning! Accident risk for children! Children are not allowed in the vicinity of the machine Prohibition to stay on the machine</p>
	<p>The product is CE marked</p>

INSTRUCTION FOR EMERGENCIES

In case of an emergency please dial 112.

Keep cell phone or emergency phone available specially when working alone. First aid kit and fire extinguishers must be kept easily accesable during all work, maintenance and service.

PERSONAL PROTECTIVE EQUIPMENT

Wear suitable clothing and footwear. Do not wear loose clothing or jewelry when working with the equipment. Remember to put up long hair when working with equipment that rotates. Use protective gloves as there is a risk of burns if any hot surfaces are touched such as exhaust pipes, and avoid getting oil and petrol on skin.

SURROUNDINGS

Check and make sure that the area is clear of people, children and objects before switching on or using the equipment. Risk of serious personal injury. Be especially careful if children are in the area where the equipment is being used or stored. Check that there are no low-hanging power lines within the work area. Be careful when working on slopes and near ditches.

Always work alone with equipment designed for single - purpose tools/products. Never have junk/debris lying in your work area. Have workspaces clean. Always respect the risk zone.

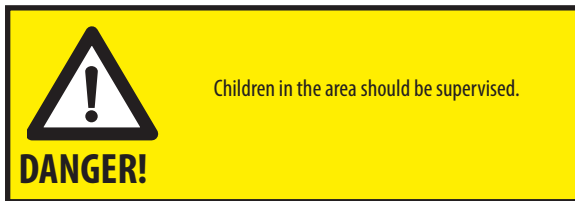

BEFORE USING

Read the instruction manual carefully. Be sure that you understand the safety information, instruction manual and warning labels. Use common sense when using and use the appropriate personal protective equipment.

Always check the performance of the machine combination to be used. Importantly, these harmonize and match in a satisfactory manner. This is to ensure the implement function and your and others' safety.

Visually inspect the gear or the product before use. Fix or replace damaged and worn parts immediately to reduce the risk of injury. Lubricate moving parts and check that all screw-nuts and bolts are tightened. Clearing when necessary.

Learn and remember the correct working methods. Beginners should always keep a low speed, use extreme caution before routine and product knowledge is achieved. The user/customer is responsible to handle the situation correctly. The product should not be taken into use unless it can be done in a safe way for the user.



USE / OPERATION

Only people who understand the safety information and instructions in this manual may operate the equipment. Be alert and careful when working with the machine and only use the tool or product in the manner described in this manual. When working with equipment that has moving parts, there is always the risk of injury. Be careful when working with equipment equipped with hydraulic hoses ,oil under pressure can penetrate the skin. Seek medical attention immediately if this occurs. Always work alone with the tools that are defined as single porpose tools. Respect the equipment's danger zone.

- Check that the trailer is intact before connecting it to the vehicle
- Connect the trailer tow bar to the vehicles hitch ball.
- The load should be evenly distributed over the carriage.
- All load that protrudes should be firmly secured
- Towing vehicles break must be applied when loading and unloading.
- Tipping should always be done on a flat surface.



Warning! It is forbidden to stay under the platform in the tilted position!

AFTER USE

- Make sure that the trailer stands on level ground when disconnecting.
- On a slope, place chocks behind the wheels before disconnecting.
- To extend the life of the product,store it under roof.
- Wash down the trailer if necessary.

TRANSPORT AND STORING

Make sure there are no people, children and foreign objects around the area before transporting the machine. Always take an extra caution during the transport. Ensure that the product is well secured and that transport brackets are mounted. Always place the load as low as possible. Respect the danger zone even during transport. When lifting the equipment, never go underneath suspended loads. Trailer used for transport should have working brakes.

Always store the machine in a dry place preferably underneath a cover when not in use. Ensure that the product is stable and not likely to tip over. Never let children play where the machine is being stored. Always keep in mind the risk of tipping!

MAINTENANCE AND SERVICE

Ensure that the unit is stable and cannot tip over during maintenance and service. Replace damaged or worn parts immediately to reduce the risk of abrasion. Always perform maintenance, service and inspection, as recommended. Use only original replacement parts or spare parts with equivalent performance to reduce the risk of damage.

Check all nuts and bolts are tightened after performing maintenance and service. Never weld towing eye as it alters the strength! Contact Kelfri for spare parts.

SERVICE	INTERVALL	MEASURE
Tires	Before each run	Check the air pressure in the tires. It should always be less than the recommended. (maximum 1.5 bar)
Wheel nuts	The first control after 2-3 hours driving Then 2-3 times / year	Tighten all the wheel nuts 90Nm
Parts of trailer	Regularly at least 3 times per year	Check visually inspect the brakes if there is, the light, LGF sign, tow eye, axles, bogie loop, hinged, flip wreath if available. Replace worn or damaged parts.
The trailer	After each run	Flush with water if necessary

ERROR	MEASURE
Load the trailer abnormally heavy	Bad wheel bearings, adjust or replace if necessary. Low air pressure, check the air pressure in all tires (1.2-1.5 bar)

ART. NO.	RESERVEDELSLISTA TV15 ATV
R23-TV15ATV.001	Wheels
R23-TV15ATV.002	Axle bogie
R23-TV15ATV.004	Pin on the lifting arm
R23-TV15ATV.005	Pin tilt
R23-TV15ATV.006	Chain rear flaps

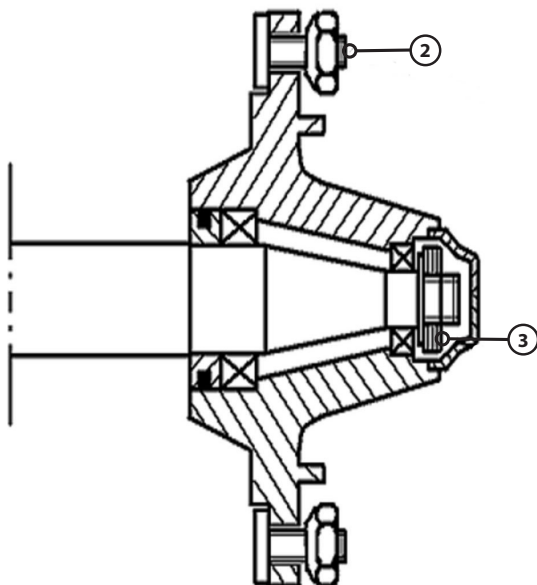

CARE INSTRUCTIONS

1. Do not overload the trailer.
2. After changing wheels, check the wheel nuts are tightened to make sure that they are tightened. The tightening torque must not exceed 45 kgm. If possible, use a torque wrench.
3. Ensure that the bearing position is correct to avoid bearing gap and abnormal wear of bearings. Bearing adjustment should rather be too loose than too tight.

RECYCLING

Disposal of the product, disassemble and transport to the municipality's recycling station. Contact your local authority for further information.

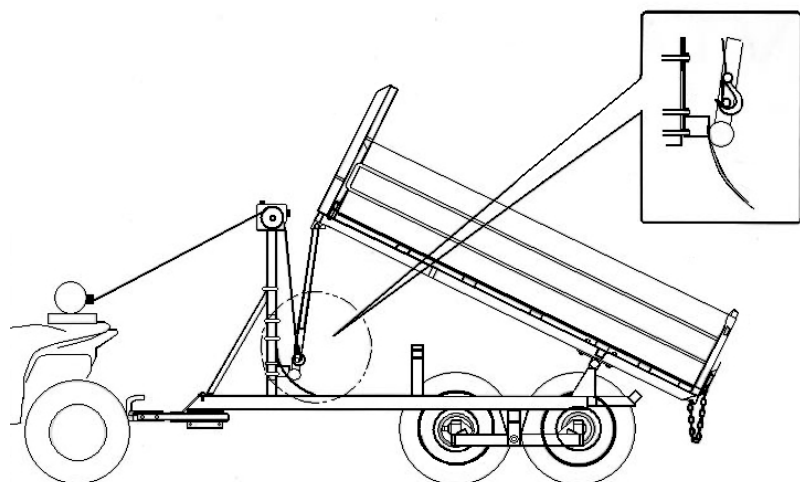

Tilting using the winch. Make sure the hook is properly secured in the pin and can not unhook. Tilt the trailer by pulling up the bed gently with the help of the winch.

WARNING! Risk of crushing! No one is allowed to stand under the suspended load!

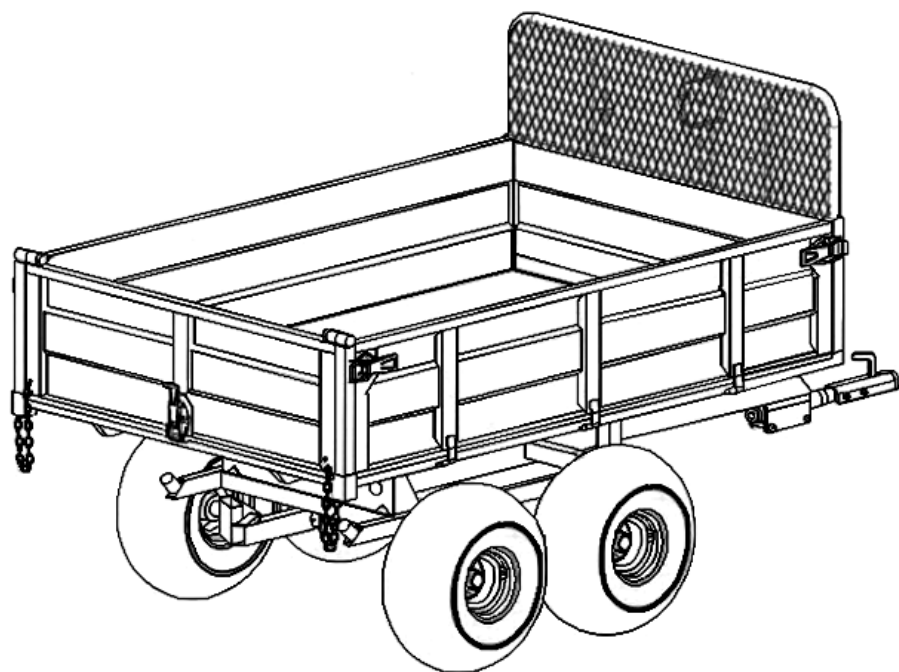

INSTALLATION INSTRUCTIONS

It is recommended that the installation is carried out by at least two persons.

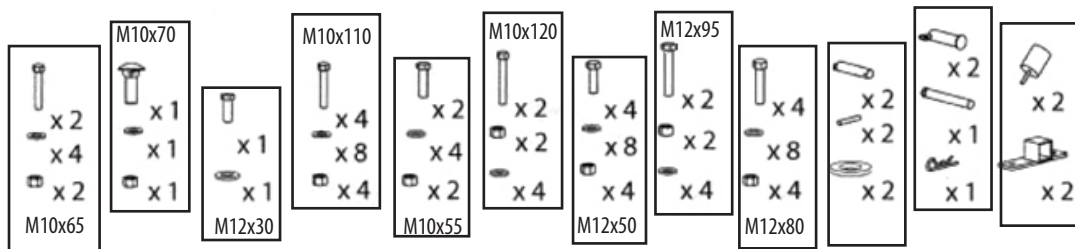
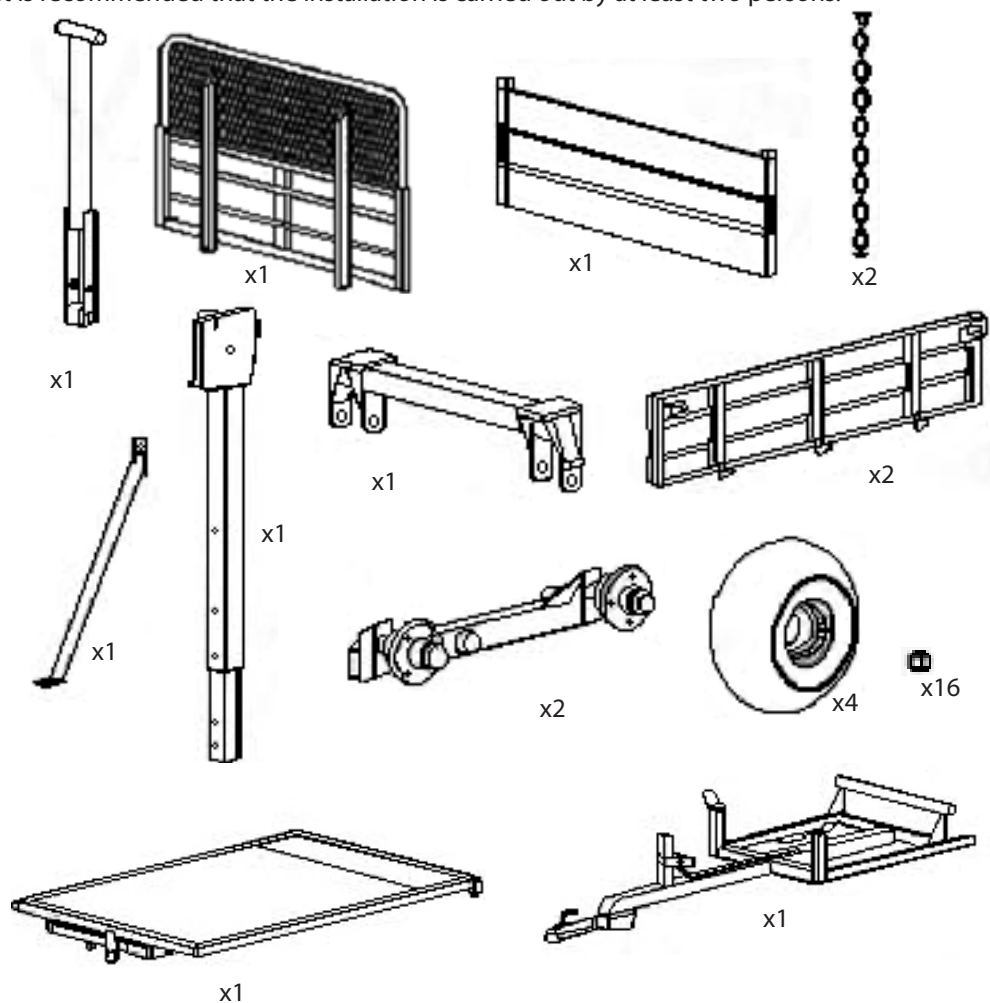

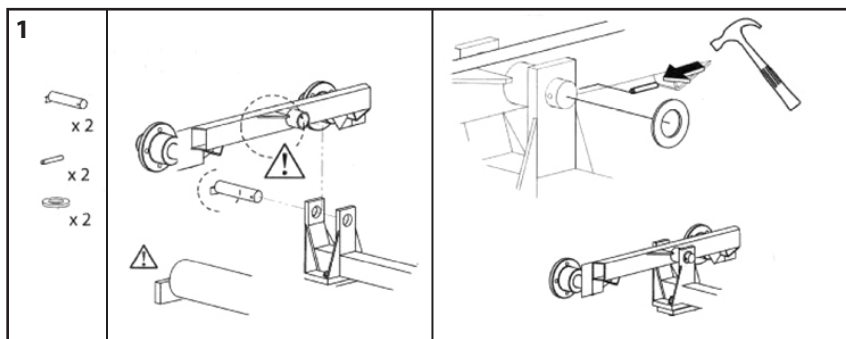

Assembling the wheel axle on the bogie. Set rear suspension with brackets upwards as illustrated to easily assemble the wheel axle. Mount the wheel axles, secured with spring pin.

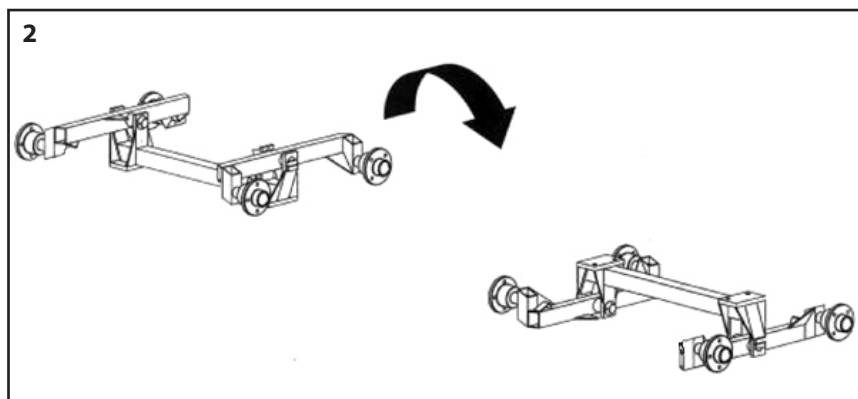

Then invert the assembled bogies for mounting the wheels.

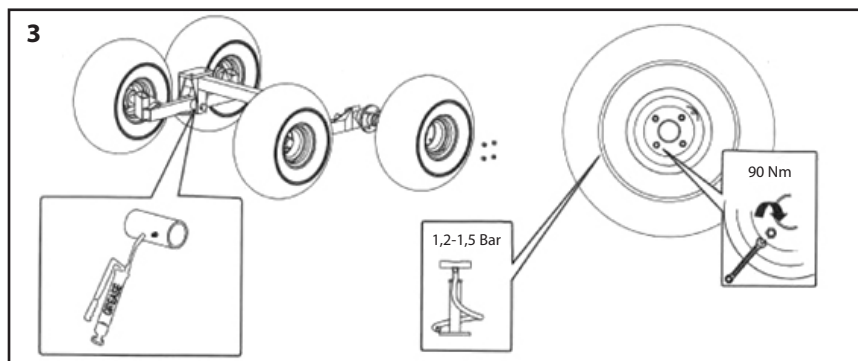

Fit the tires, lubricate the axle shaft and then check the air pressure of each wheel

4

M12x50
x 4
x 8
x 4
x 2

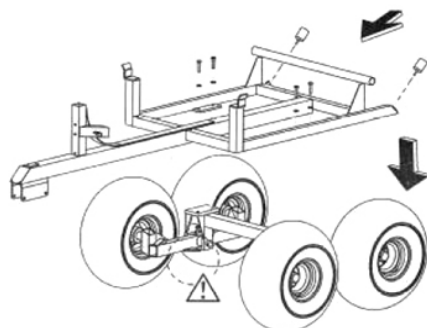

Install the platform frame on the bogie. Tighten all bolts.

5

M12x80
x 4
x 8
x 4
x 2

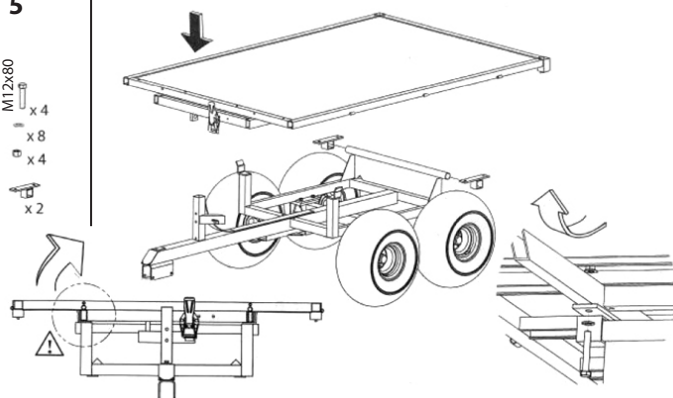

Fit the brackets on the frame and tighten the platform bed. Tighten all bolts

6

M12x95
x 2
x 2
M10x55
x 2
x 2

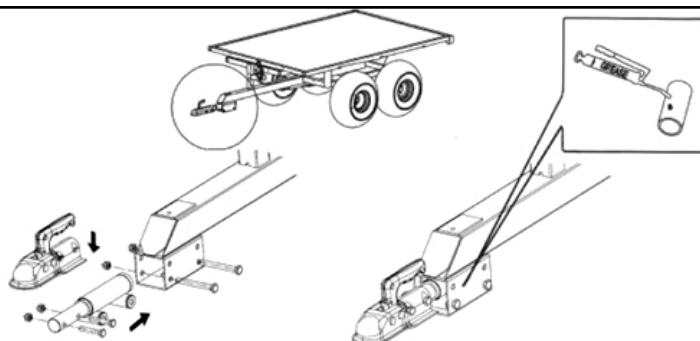

Installation of the towing device. Do not forget to lubricate moving parts.

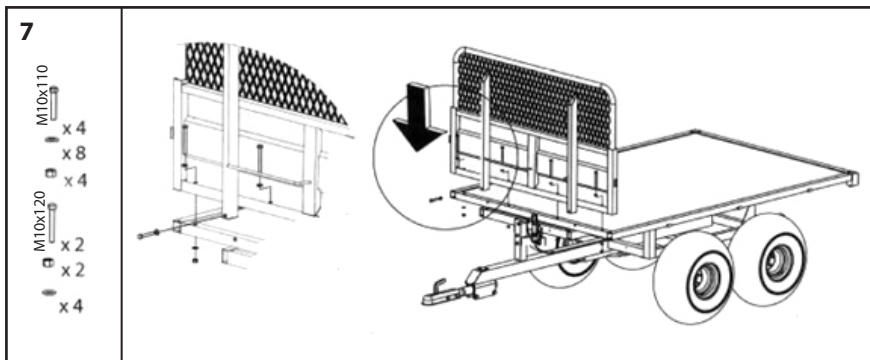

Front gate assembly

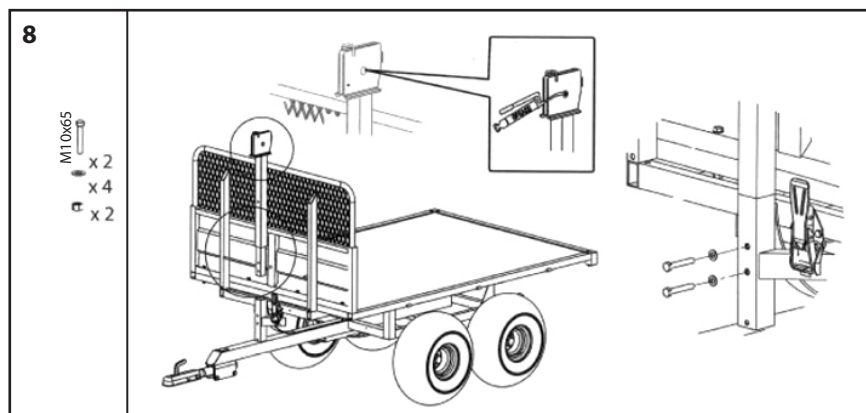

Install bar with wire block for the wire. Do not forget to lubricate the wire block.

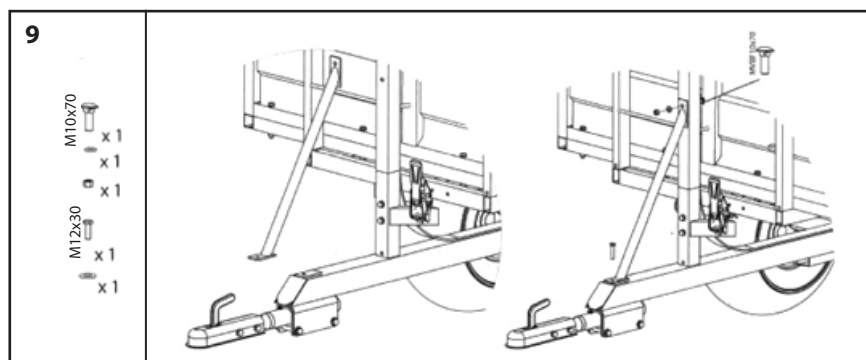

Mount the stabilizer bar.

10

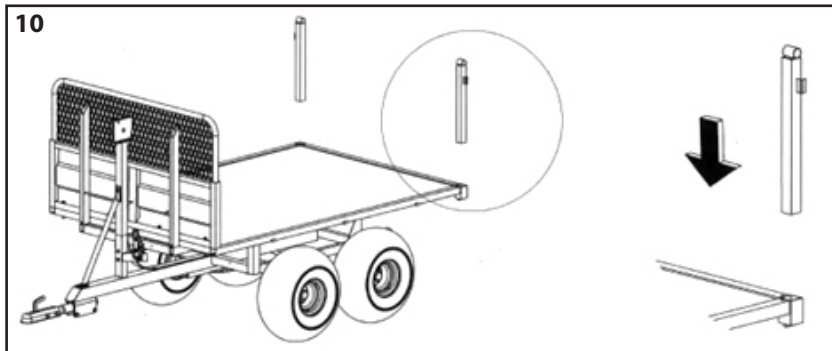

Fit the bars for mounting the side and rear flaps.

11

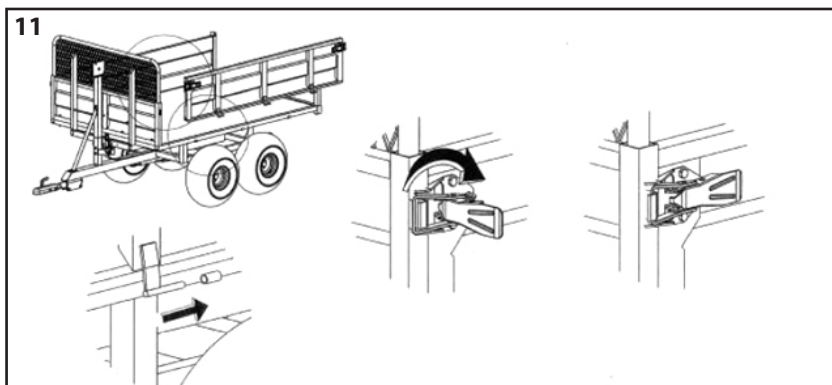

Optional: extension flaps.

- Mounted on the trailers existing flaps.
- Drill holes in the boards and mount them.

See the figure below for hole size and hole distance measurement (mm).

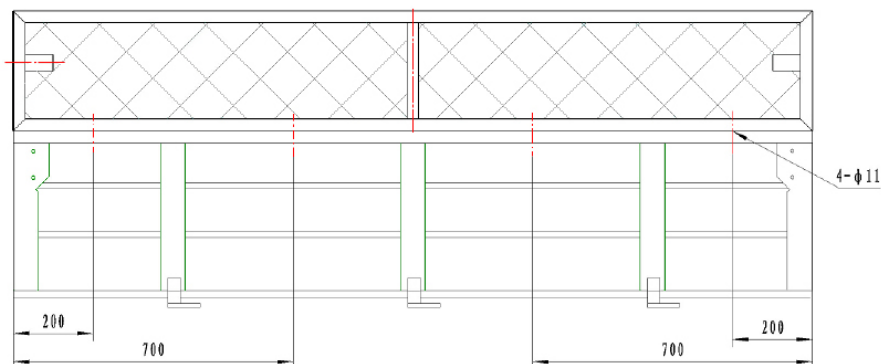

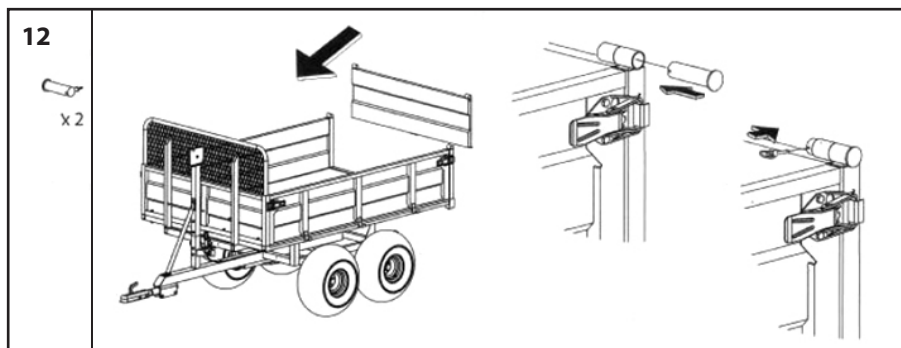

Fitting the rear flaps

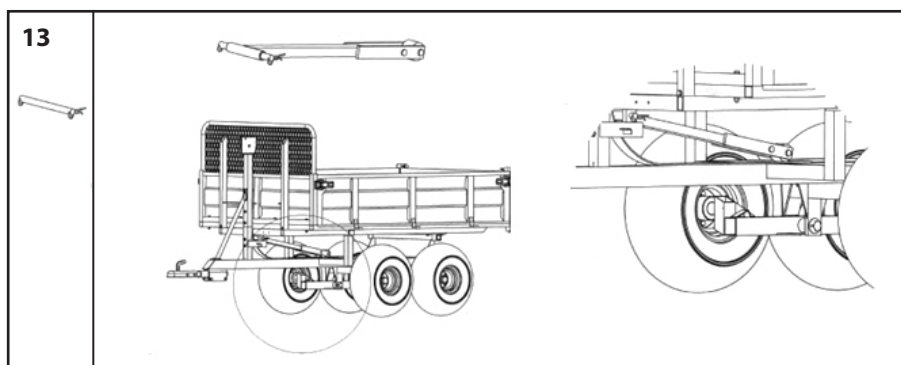

Mount the lifting arm under the bed. Then check that the pins are secured and can not loosen.

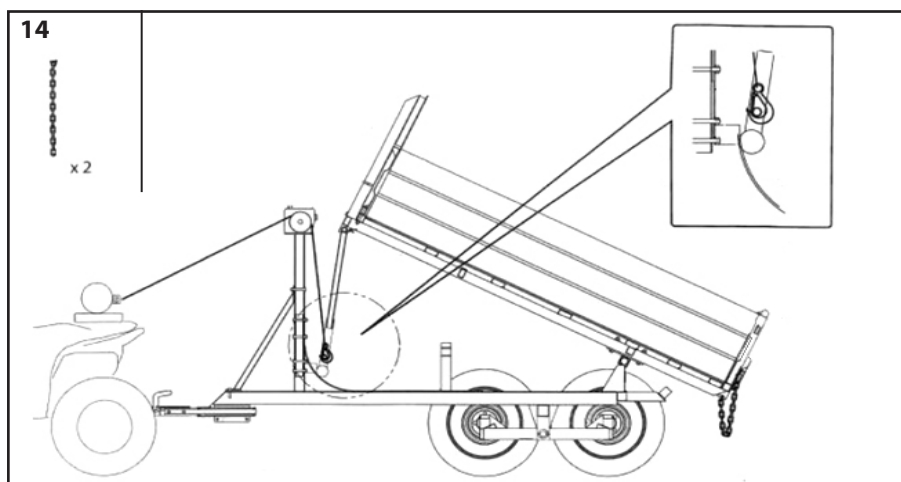

Install the chains on the tailgate.

WARRANTY TERMS AND CONDITIONS

- | | |
|-----------------------------|--|
| Validity of the warranty | - Kelifri's Warranty is valid 12 months from the date of purchase |
| This warranty replaces | - Compensation for spare parts after acknowledgment that the fault lies on the material or manufacturing defects. |
| This guarantee do not cover | <ul style="list-style-type: none">• Labour costs• Travel expenses• Any modification that the buyer himself has/had made.• Any consequential damages that occurred out of damage to the machine.• Damage due to normal deterioration of the machine, inadequate: service, user inexperience or use of spare parts which are not original.• Wear parts such as hoses, seals, oils, and mechanical belts |

EG-FÖRSÄKRAN OM MASKINENS ÖVERENSTÄMMELSE, ORIGINAL

EC-DECLARATION OF CONFORMITY

According to 2006/42/EC, Annex 2A

Kelfri AB

Munkatorpsgratan 6

532 37 Skara, Sweden

Declares that the machine

Name: 23-TV15ATV

Type: Tiping trailer

Complies with all applicable provisions of the Machinery Directive 2006/42/EC.

Other equipment must meet the hardware requirements of the Directive

Tina Baudtler, VD

Kelfri AB is constantly working on further developing their products and therefore reserves the right to modify, among other things the design and appearance without notice

2015-09-22

CUSTOMER SERVICE

You are always welcome to give your feedbacks, reviews or ask us about our tools and products.

KELLFRI AB

Phone : 0511 - 242 50

Fax: 0511 - 168 33

E-mail : info@kelfri.se